

# RESERVEDELSKATALOG

## H A F 2-VINGET ROTORKLIPPER

### MODEL

HF200006 105CM  
HF200011 125CM

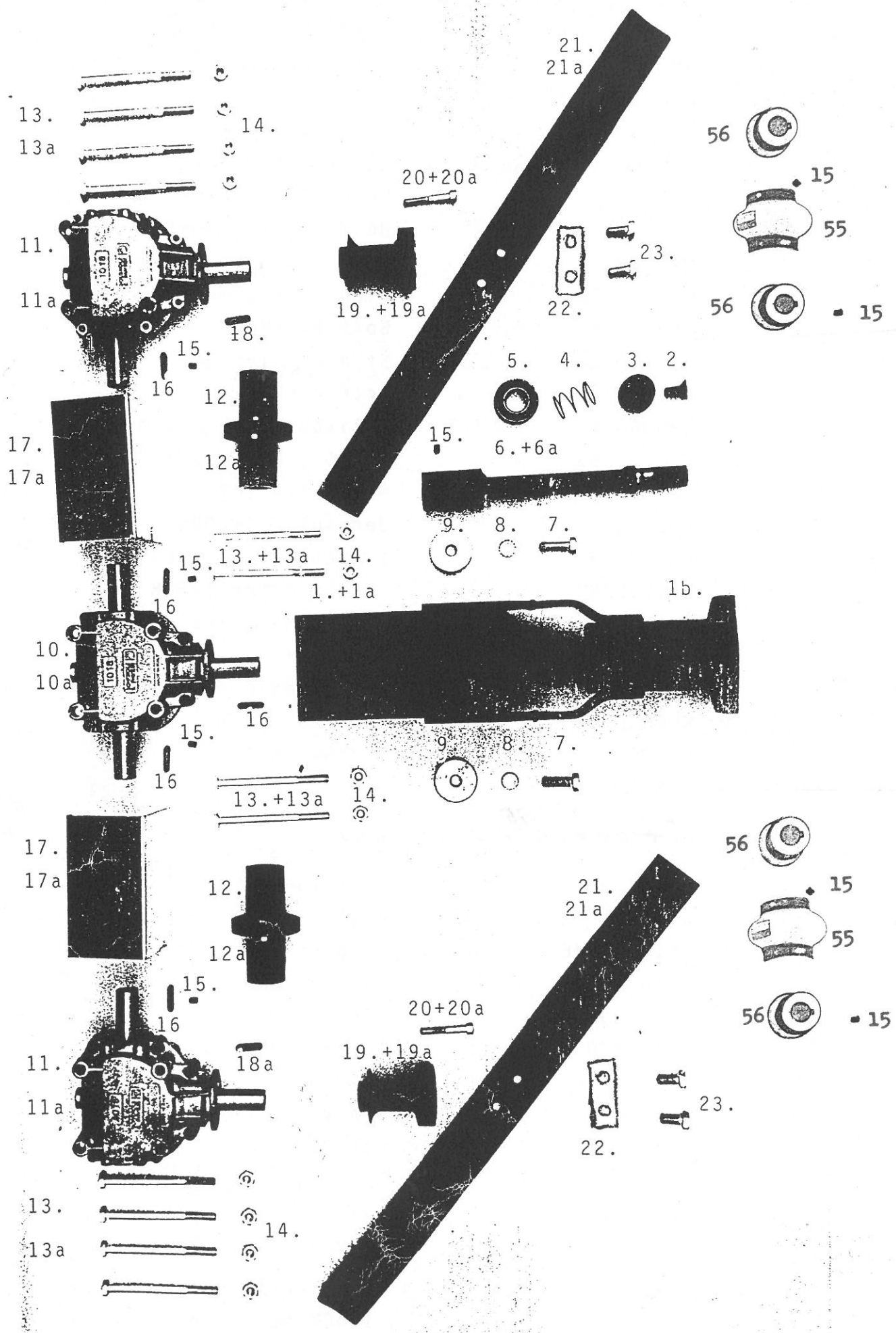

39

38+38a

35  
35a

25.  
25a

28  
27  
26

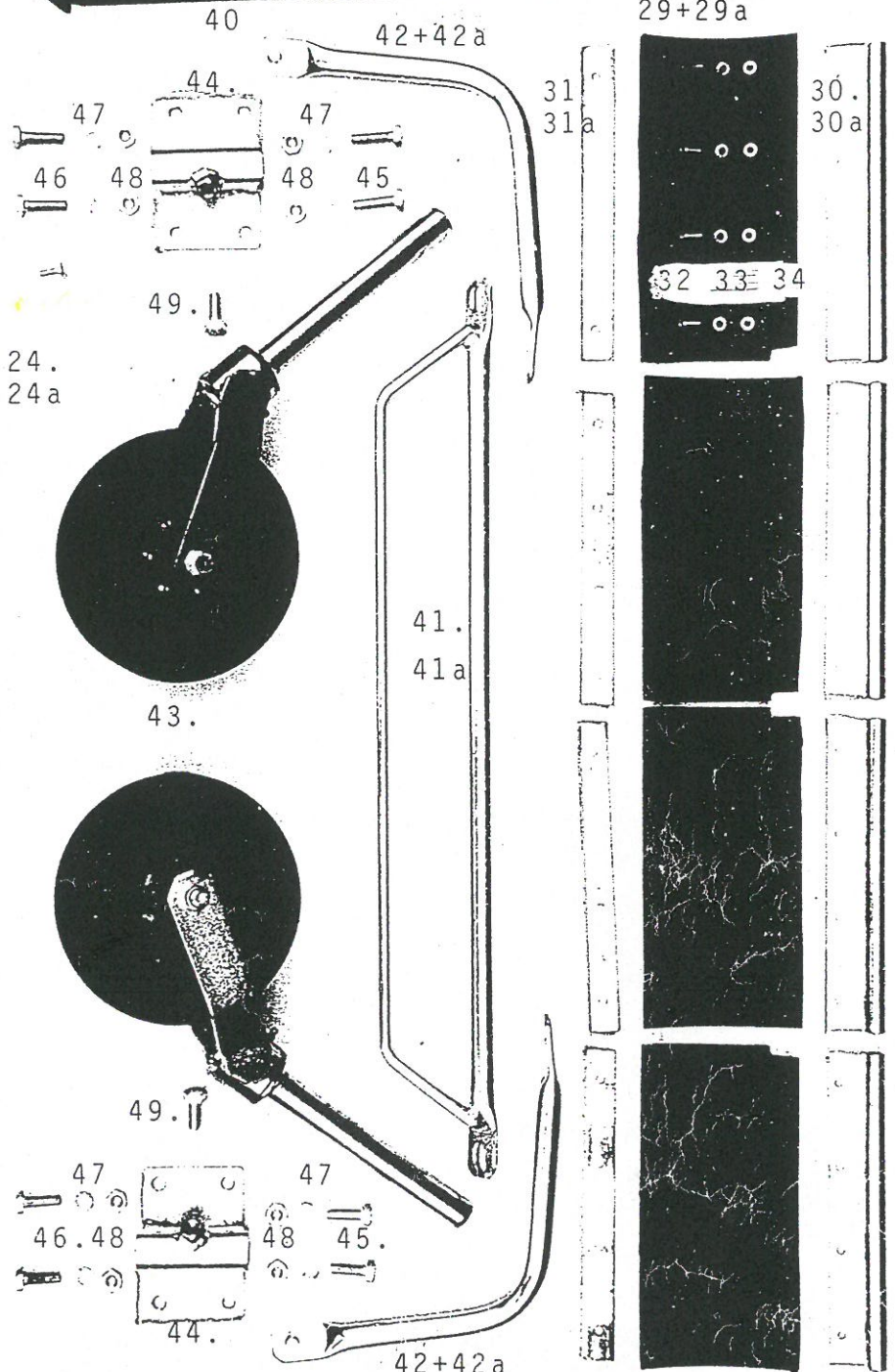

50.

51.

53

52

38+38a

36  
37

2 - V I N G E T R O T O R K L I P P E R A E - G 7 1 9

BILLEDNR.	RESERVEDELSNR.	ANTAL	BENÆVNELSE
1	H2000001	1	Konsol for gear 25MM
1a	H2000001B	1	Konsol for gear 30MM
1b	H1000036	1	Forflange
2	ANUN12-BOLT	1	Undersænket umbracobolt 12+25MM
3	H2000003	1	PTO bøsning 4-klo
4	H2000004	1	Fjeder for 4-klo
5	SKF6205-2RS	1	Kugleleje
6	H2000006	1	PTO aksel 25MM
6a	H2000006B	1	PTO aksel 30MM
7	AN12-BOLT	2	Bolt 12+35MM
8	AN12-SKIVE	2	Stjerneskiye 12MM
9	H2000009	2	Specialskive 12MM
10	H2000010	1	T-drev "S1018100G222 25MM"
10a	H2000010B	1	T-drev "S1020100G333 30MM"
11	H2000011	2	V-drev "S1018278F202 25MM"
11a	H2000011B	2	V-drev "S1020278R330 30MM"
12	H2000012	2	Akselkobling 25MM
12a	H2000012B	2	Akselkobling 30MM
13	AN10-BOLT	12	Bolt 10+120MM 25MM
13a	AN10-BOLT	12	Bolt 10+130MM 30MM
14	AN10-MØTRIK	12	Møtrik 10MM
15	9PINOLSKRUE	5	Pinolskrue 8+10MM
16	9NOT	4	Not 8+7+25MM for 105CM
16a	9NOT	4	Not 8+7+40MM for 125CM
17	H2000017	2	Beskyttelsesskærm for 105CM
17a	H2000017B	2	Beskyttelsesskærm for 125CM
18	9NOT	2	Not 8+7+25mm for 105CM
18a	9NOT	2	Not 8+7+40MM for 125CM
19	H2000019	2	Knivholder for 105CM
19a	H2000019B	2	Knivholder for 30MM
20	ANUN-BOLT	2	Umbracobolt 8+55 for 25MM
20a	ANUN10-BOLT	2	Umbracobolt 10+30 for 30MM
21	H2000021	1	Kniv for 105CM højre
21a	H2000021A	1	Kniv for 105CM venstre
21b	H2000021B	1	Kniv for 125CM højre
21c	H2000021C	1	Kniv for 125CM venstre
22	H2000022	2	Låseblik
23	AN12-BOLT	2	Bolt 12+25MM
24	H2000024	1	Frontgummi for 105CM
24a	H2000024B	1	Frontgummi for 125CM
25	H2000025	1	Støtteskinne for 105CM
25a	H2000025B	1	Støtteskinne for 125CM

BILLEDNR.	RESERVEDELSNR.	ANTAL	BENÆVNELSE
26	AN6-BOLT	6	Bræddebolt 6+20MM
27	AN6-SKIVE	6	Stjerneskiye 6MM
28	AN6-MØTRIK	6	Møtrik 6MM
29	H2000029	4	Gummiflap for 105CM
29a	H2000029B	4	Gummiflap for 125CM
30	H2000030	4	Holder for gummiflap 105CM
30a	H2000030B	4	Holder for gummiflap 125CM
31	H2000031	4	Plade for gummiflap 105CM
31a	H2000031B	4	Plade for gummiflap 125CM
32	AN6-BOLT	16	Bolt 6+16MM
33	AN6-SKIVE	16	Stjerneskiye 6MM
34	AN6-MØTRIK	16	Møtrik 6MM
35	H2000035	1	Splitbolt for 105CM
35a	H2000035B	1	Splitbolt for 125CM
36	AN10-SKIVE	1	Planskive 10MM
37	9SPLIT	1	Jernsplit 3+30MM
38	H2000038	2	Slæbesko for 105CM
38a	H2000038B	2	Slæbesko for 125CM
39	AN10-SKIVE	4	Svær 10MM skive
40	AN10-BOLT	4	Bolt 10+20
41	H2000041	1	Midterbøjle for 105CM
41a	H2000041B	1	Midterbøjle for 125CM
42	H2000042	2	Sidebøjle for 105CM H+V
42a	H2000042B	2	Sidebøjle for 125CM H+V
43	<del>H1135075</del>	2	Støttehjul kpl.
44	H2000044	2	Hjulholder
45	AN10-BOLT	4	Bolt 10+25MM
46	AN10-BOLT	4	Bolt 10+30MM
47	AN10-SKIVE	8	Fjederskiye 10MM
48	AN10-MØTRIK	8	Møtrik 10MM
49	AN12-BOLT	2	Justerbolt 12+45
50	H2000050	1	Holder for bøjle højre
50a	H2000050B	1	Holder for bøjle venstre
51	H2000051	2	Beskyttelsesbøjle
52	AN8-BOLT	4	Bolt 8+16MM
53	AN8-SKIVE	4	Spændeskiye 8MM
54	H2000054	1	Klipperskjold 105CM "ikke vist"
54a	H2000054B	1	Klipperskjold 125cm "ikke vist"
55	H2000012C	2	KOBL. ELEMENT OMEGA E3, 25MM
	H2000012D	2	KOBL. ELEMENT OMEGA E4, 30MM
56	H2000056	4	NAV F. ELEMENT, 25MM
	H2000056B	4	NAV.F. ELEMENT, 30MM

LØST HJUL  
H1135057