

Planche n°1

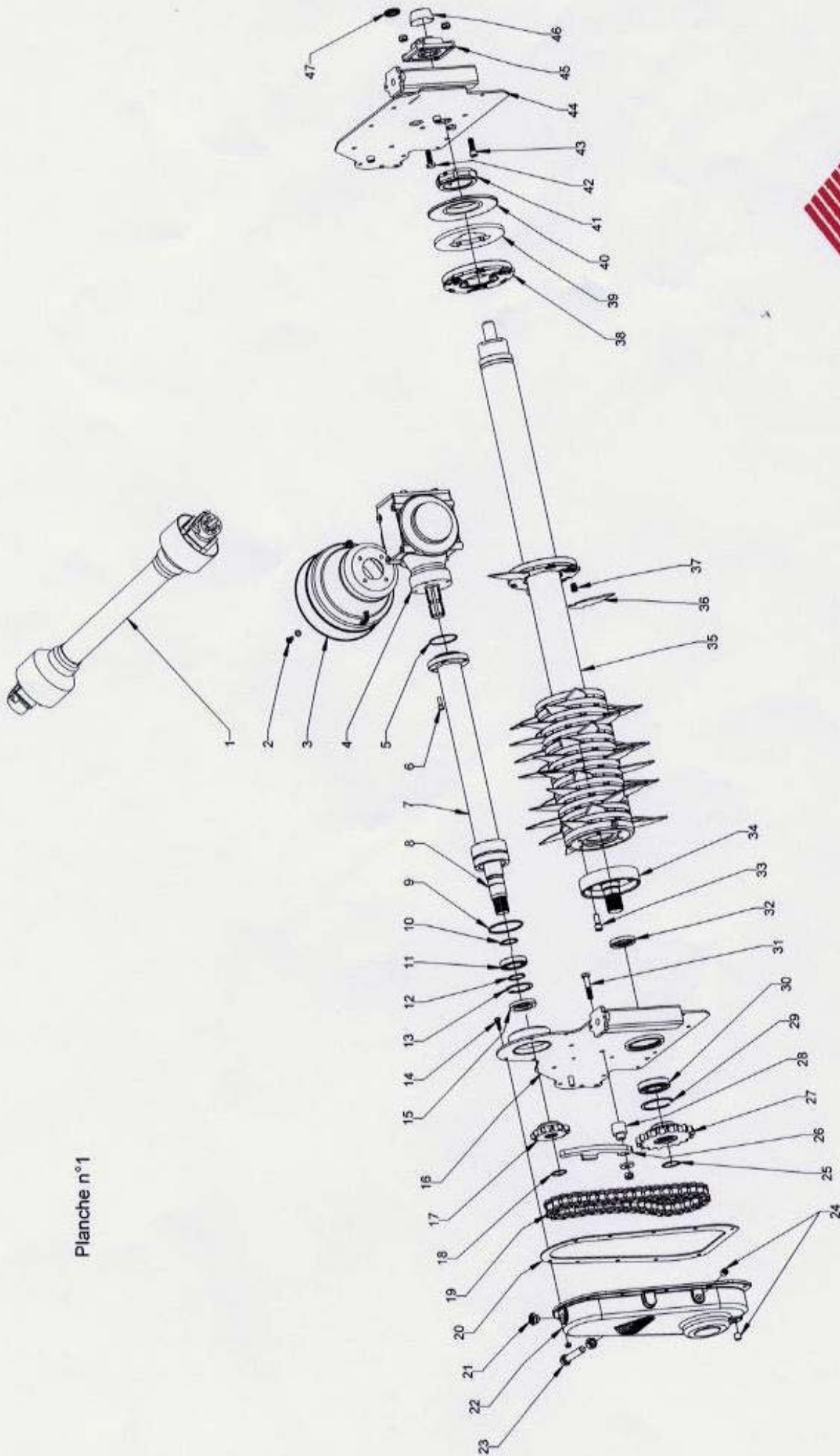

PARTIE ENTRAINEMENT ED 130



Planche n° 1



PARTIE ENTRAINEMENT ED 130

Planche n°2

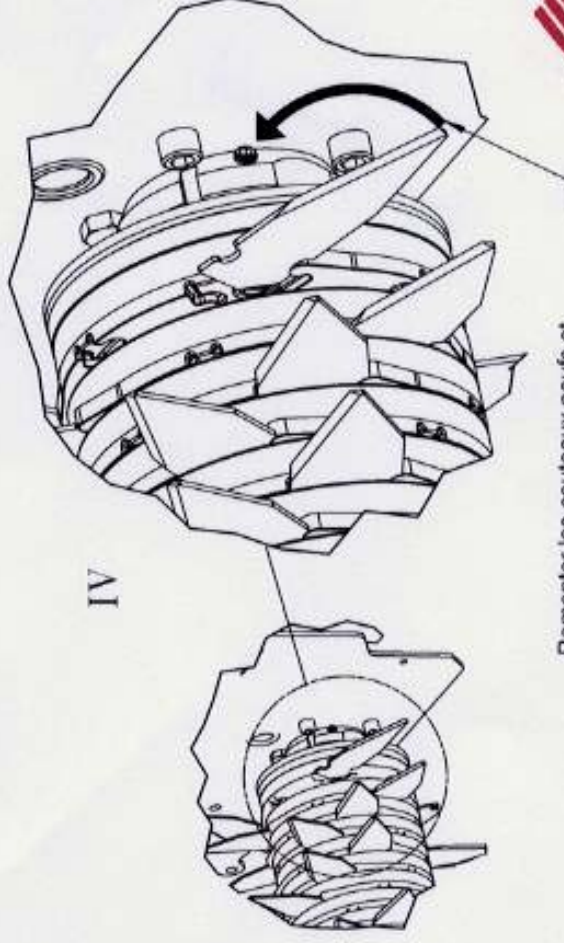
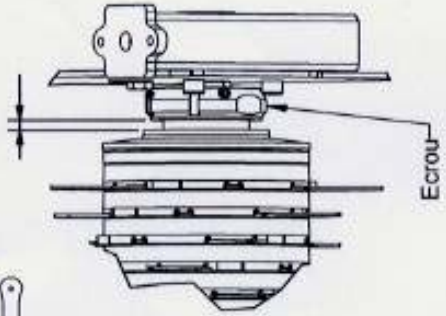
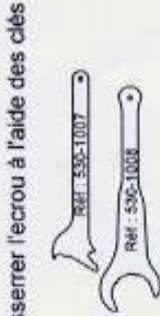
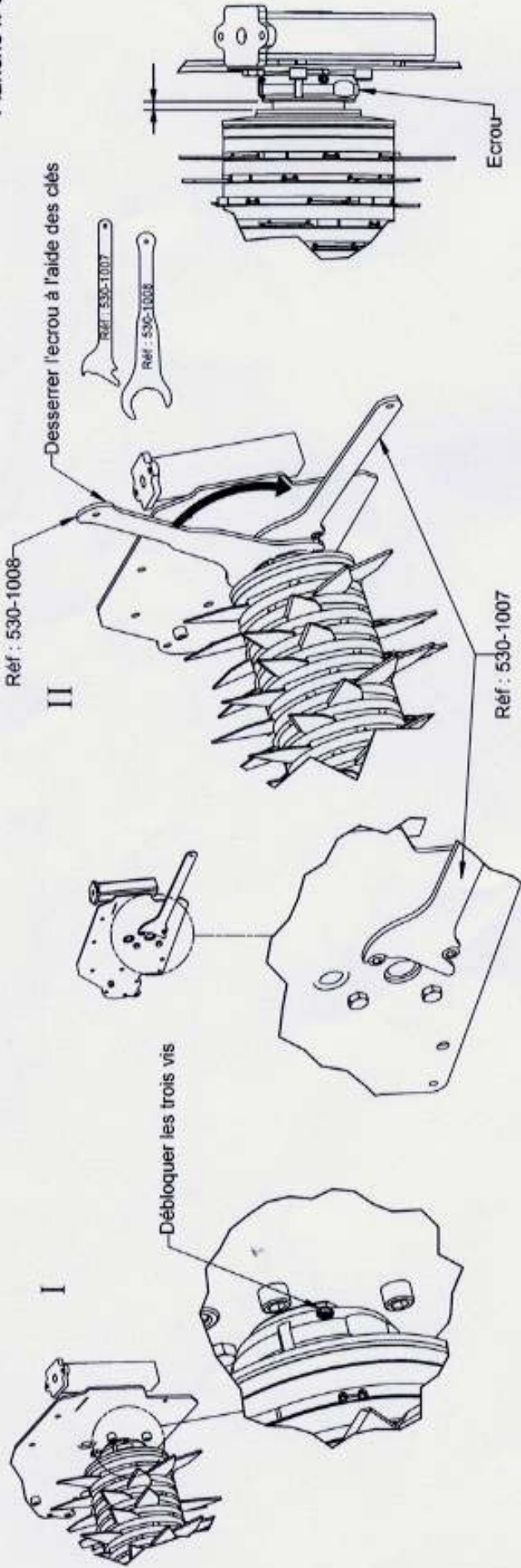
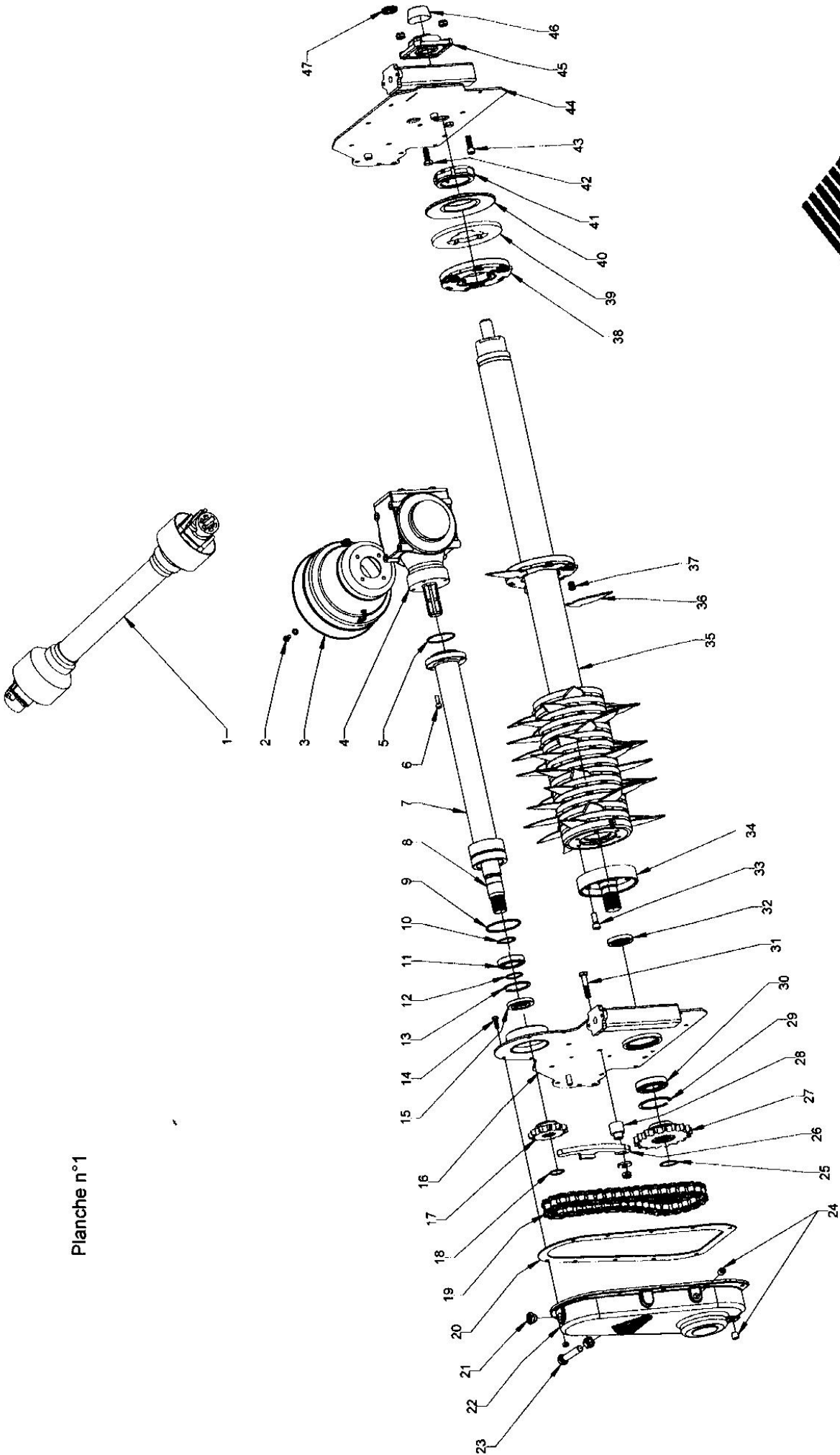
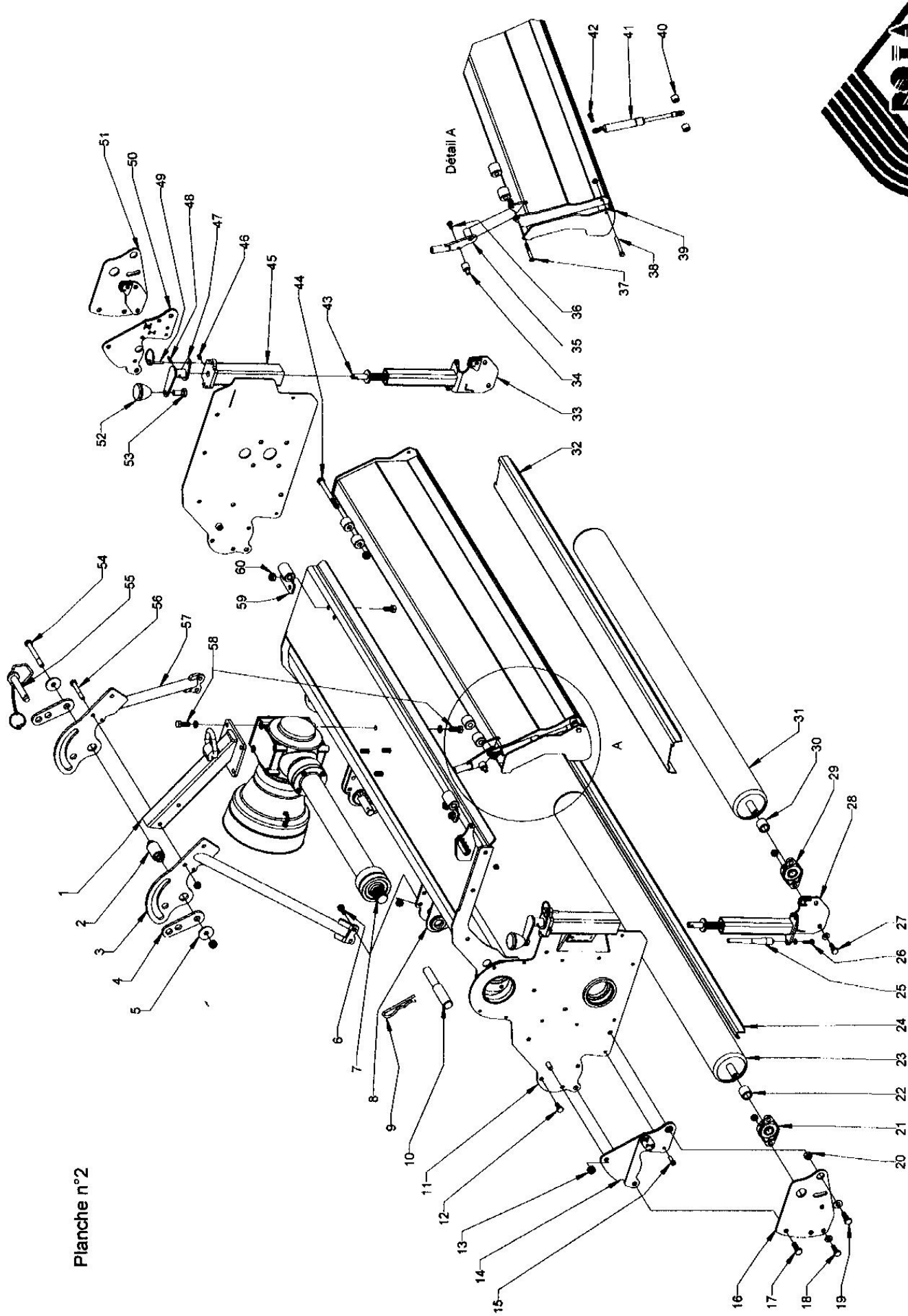

CARROSSERIE ED 130

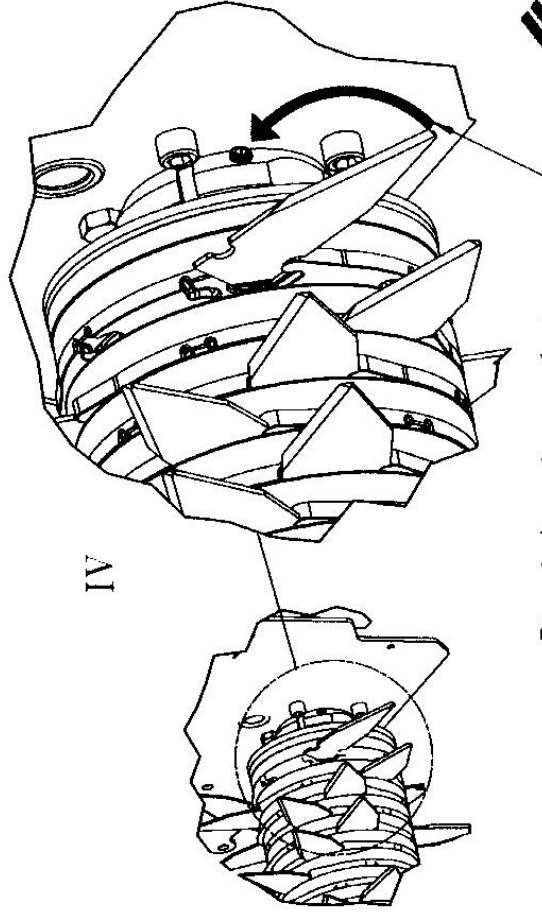
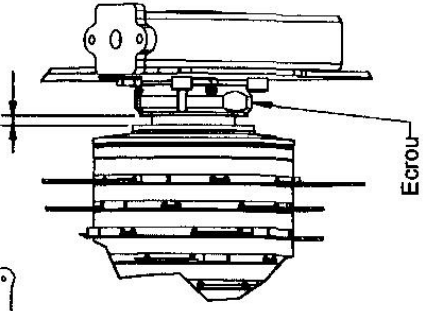
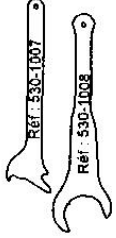
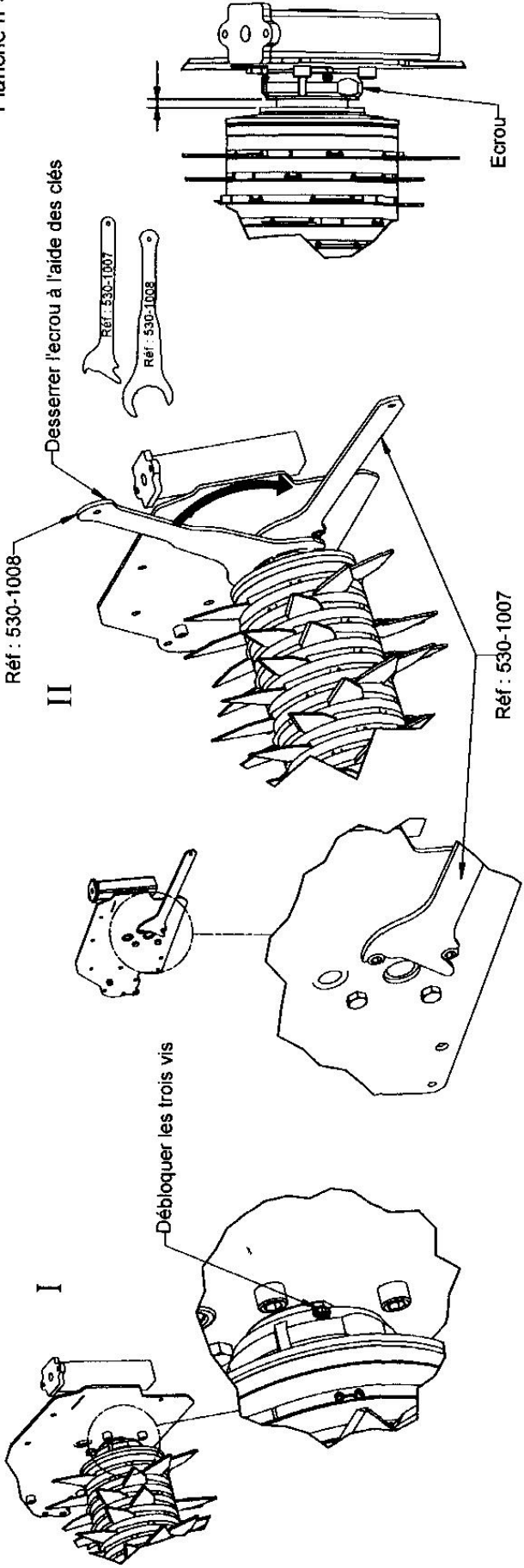

Remonter les couteaux neufs et  
renouveler les opérations dans le sens inverse

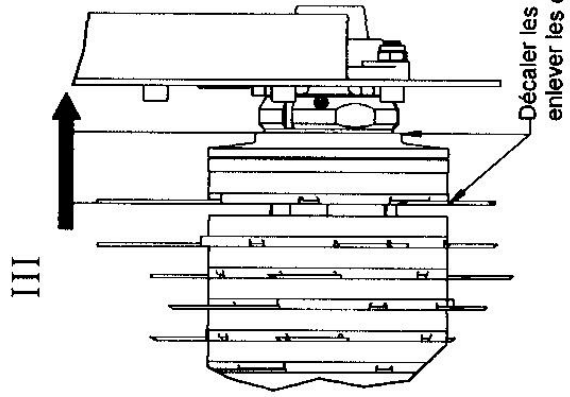

**NOMENCLATURE PLANCHE N°1 ED 130**

**SPARE PARTS DRAWING NR 1 ED 130**

<b>REP NR</b>	<b>DESIGNATION (Français)</b>	<b>DESIGNATION (english)</b>	<b>REFERENCES PIECES PARTS REFERENCES</b>	<b>QTE QTY</b>
1	TRANSMISSION	TRANSMISSION	094-1010	1
2	VIS T.H 8 * 16 ZBJ	SCREW T.H 8 * 16 ZBJ	850-2036	4
	RONDELLE MU Ø8	WASHER MU Ø8	695-1062	4
3	BOL DE PROTECTION	GUARDING BOWL	093-1005	1
4	BOITIER RENVOI D'ANGLE	GEAR BOX	095-1014	1
5	JOINT O.R Ø65 * 3	RING O.R Ø65 * 3	400-1021	1
6	VIS CHC 8 * 25	SCREW CHC 8 * 25	850-3003	4
7	TROMPETTE	TRUMPET	095-1015	1
8	ARBRE SECONDAIRE	SECONDARY SHAFT	100-U095	1
9	JOINT O.R Ø82 * 4	RING O.R Ø82 * 4	400-1025	1
10	CIRCLIPS Ø40 EXT.	SPRING RING Ø40 EXT.	190-1001	1
11	ROULEMENT 6008	BALL BEARING 6008	690-1046	1
12	CIRCLIPS Ø40 EXT.	SPRING RING Ø40 EXT.	190-1001	1
13	CIRCLIPS Ø 68 INT.	SPRING RING Ø 68 INT.	190-1023	1
14	VIS T.H 8 * 25 DIN 933	SCREW T.H 8 * 25 DIN 933	850-2024	10
	ECROU M8 DIN 985	NUT M8 DIN 985	260-1010	10
15	BAGUE D'ETANCHEITE 40 * 68 * 10 SL	PACKING RING 40 * 68 * 10 SL	400-1026	1
16	COTE GAUCHE	LEFT SIDE	3130-195-1023	1
17	PIGNON DE CHAINE	GEAR	600-1010	1
18	CIRCLIPS Ø 35 EXT.	SPRING RING Ø 35 EXT.	190-1009	1
19	CHAINE	CHAIN	175-1005	1
20	JOINT LIEGE	CORK GASKET	420-1007	1
21	BOUCHON TCD 1/2	CAP TCD 1/2	155-1003	1
22	CARTER DE CHAINE	CHAIN CASE	180-1019	1
23	VIS T.H 16 * 80 DIN 933	SCREW T.H 16 * 80 DIN 933	850-2011	1
	ECROU M 16 . 4032	NUT M 16 . 4032	260-1015	1
24	BOUCHON 3/8 G	CAP 3/8 G	155-1001	2
25	CIRCLIPS Ø40 EXT.	SPRING RING Ø40 EXT.	190-1001	1
26	TENDEUR DE CHAINE	CHAIN TIGHTENER	5075-730-1002	1
27	PIGNON DE CHAINE	CHAIN GEAR	600-1012	1
28	DOUILLE DE TENDEUR	BUSHING - CHAIN TIGHTENER	240-1020	1
29	CIRCLIPS Ø 80 INT.	SPRING RING Ø 80 INT.	190-1008	1
30	ROULEMENT 6208	BALL BEARING 6208	690-1004	1
31	VIS T.H 12 * 60 DIN 931	SCREW T.H 12 * 60 DIN 931	850-2009	1
	RONDELLE DE TENDEUR	WASHER - CHAIN TIGHTENER	695-1057	1
	ECROU M 12 DIN 985	NUT M 12 DIN 985	260-1012	1
32	BAGUE D'ETANCHEITE 45 * 65 * 10 D.L	PACKING RING 45 * 65 * 10 D.L	400-1009	1
33	VIS CHC 12 * 30 CL 12.9	SCREW CHC 12 * 30 CL 12.9	850-3019	6
34	PLATEAU D'ENTRAINEMENT	TRANSMISSION SHAFT	5075-630-1008	1
35	ROTOR	ROTOR	3130-760-1181	1
36	COUTEAU	KNIFE	450-1055	159
37	AIMANT	MAGNET	647-1001	159
38	FLASQUE	DISC - ROTOR	280-U073	53
39	FLASQUE DROIT	RIGHT EDGE DISC - ROTOR	280-1069	1
40	RONDELLE BELLEVILLE	WASHER	695-1095	1
41	ECROU DE BLOCAGE DE ROTOR	LOCKER NUT - ROTOR	260-1027	1
42	VIS T.H 12 * 35 DIN 933	SCREW T.H 12 * 35 DIN 933	850-2018	2
	ECROU M 12 DIN 985	NUT M 12 DIN 985	260-1012	2
43	VIS CHC M 12 * 35	SCREW CHC M 12 * 35	850-3015	2
	ECROU M 12 DIN 985	NUT M 12 DIN 985	260-1012	2
44	COTE DROIT	RIGHT SIDE	3130-195-1024	1
45	PALIER SF 30	BEARING SF 30	690-1045	1
46	COUVERCLE DE PALIER	COVER - BEARING	197-1005	1
47	BOUCHON	CAP	156-1005	1

**NOMENCLATURE PLANCHE N°2 ED 130**

1 / 2

**SPARE PARTS DRAWING NR 2 ED 130**

1/2

REP NR	DESIGNATION (Français)	DESIGNATION (english)	REFERENCES PIECES PARTS REFERENCES	QTE QTY
1	ATTELAGE 3 Pts	TOPLINK FRAME	3130-750-1255	1
2	DOUILLE ENTRETOISE	SPACER BUSHING	240-1102	1
3	TIRANT GAUCHE	LEFT TIE ROD - TOPLINK	3130-760-G182	1
4	PLAT D'OSCILLATION ATTELAGE	ROTATING PLATE - TOP LINKS	640-1277	2
5	RONDELLE	WASHER	695-1027	2
6	VIS T.H 10 * 25 DIN 933	SCREW T.H 10 * 25 DIN 934	850-2003	4
	ECROU M 10 DIN 985	NUT M 10 DIN 986	260-1011	4
7	VOIR PLANCHE N°1	SEE PARTS LIST NR 2		
8	CAPOT	BODY FRAME CHASSIS	3130-770-1172	1
9	GOUPILLE BETA Ø 6	GOUPILLE BETA Ø 7	340-1001	2
10	AXE DOUBLE 22 / 28	AXIS 22/28	120-U002	2
11	COTE GAUCHE	LEFT SIDE	3130-195-1023	1
12	VIS T.H 10 * 25 DIN 933	SCREW T.H 10 * 25 DIN 934	850-2003	12
	ECROU M 10 DIN 985	NUT M 10 DIN 986	260-1011	12
13	ECROU M 12 DIN 985	NUT M 12 DIN 986	260-1012	2
14	CALE AV. GAUCHE	LEFT FRONT STOP	3130-163-G012	1
15	VIS CHC 8 * 25	SCREW CHC 8 * 26	850-3003	2
	ECROU M 8 DIN 985	NUT M 8 DIN 986	260-1010	2
16	FLANC GAUCHE ROULEAU AV.	LEFT FLANGE - FRONT ROLLER	3130-270-G123	1
17	VIS T.H 12 * 35	SCREW T.H 12 * 36	850-2018	2
	ECROU M 12 DIN 985	NUT M 12 DIN 986	260-1012	2
18	VIS T.H 10 * 35 DIN 933	SCREW T.H 10 * 35 DIN 934	850-2022	4
	RONDELLE MU Ø10	WASHER MU Ø11	695-1017	4
	ECROU M 10 DIN 985	NUT M 10 DIN 986	260-1011	4
19	VIS T.H 12 * 35	SCREW T.H 12 * 36	850-2018	2
	RONDELLE MU Ø 12	WASHER MU Ø 13	695-1018	2
	ECROU M 12 DIN 985	NUT M 12 DIN 986	260-1012	2
20	DOUILLE	BUSHING	240-1030	2
21	PALIER UCFL 204	BEARING UCFL 205	690-1040	2
22	DOUILLE	BUSHING	240-1105	2
23	ROULEAU	ROLLER	3130-760-1198	1
24	GRATTOIR AV.	FRONT SCRAPER	770-1207	1
25	INDEX DE HAUTEUR	DEPTH GAUGE	120-1057	2
26	VIS T.H 8 * 25	SCREW T.H 8 * 26	850-2024	2
	RONDELLE MU Ø 8	WASHER MU Ø 9	695-1062	2
27	VIS T.H 10 * 30 DIN 933	SCREW T.H 10 * 30 DIN 934	850-2002	4
	RONDELLE MU Ø10	WASHER MU Ø11	695-1017	4
	ECROU M 10 DIN 985	NUT M 10 DIN 986	260-1011	4
28	FLANC GAUCHE ROULEAU AR.	LEFT FLANGE - REAR ROLLER	3130-270-G115	1
29	PALIER UCFL 204	BEARING UCFL 205	690-1040	2
30	DOUILLE	BUSHING	240-1105	2
31	ROULEAU	ROLLER	3130-760-1198	1

**NOMENCLATURE PLANCHE N°2 ED 130**

2 /2

**SPARE PARTS DRAWING NR 2 ED 130**

2/2

<b>REP NR</b>	<b>DESIGNATION (Français)</b>	<b>DESIGNATION (english)</b>	<b>REFERENCES PIECES</b>	<b>QTE QTY</b>
32	GRATTOIR AR.	REAR SCRAPER	770-1208	1
33	FLANC DROIT ROULEAU AR.	RIGHT FLANGE - REAR ROLLER	3130-270-D115	1
34	AXE DE ROCHET	RATCHET AXIS	120-1056	1
35	POIGNEE DE ROCHET	RATCHET HANDLE	3130-610-1014	1
36	VIS T.H 8 * 16	SCREW T.H 8 * 17	850-2036	1
37	VIS FHC 8 * 60 INOX	SCREW FHC 8 * 60 INOX	850-2054	1
	ECROU M 8 DIN 985	NUT M 8 DIN 986	260-4005	1
38	VIS T.H 8 * 60	SCREW T.H 8 * 61	850-2047	1
	ECROU M 8 DIN 985	NUT M 8 DIN 986	260-1010	1
39	PORTE ARRIERE	REAR GATE	3130-770-1174	1
40	DOUILLE ENTRETOISE	TUBULAR BRACING	240-1103	2
41	VERIN GAZ	GAS CYLINDER	780-1001	1
42	VIS T.H 8 * 20	SCREW T.H 8 * 21	850-2055	1
43	VIS DE MANIVELLE	SCREW FOR CRANK	5100-850-1039	2
44	VIS T.H 12 * 130	SCREW T.H 12 * 131	850-2013	2
	ECROU M 12 DIN 985	NUT M 12 DIN 986	260-1012	2
45	COTE DROIT	RIGHT SIDE	3130-195-1024	1
46	GRAISSEUR	GREASER	320-1001	2
47	MANIVELLE	CRANK	6076-640-1228	2
48	GOUPILLE ELASTIQUE Ø6 * 25	PEG Ø6 * 26	340-1007	2
49	GOUPILLE CLIPS Ø6	PEG CLIPS Ø7	340-1005	2
50	CALE AV. DROIT	FRONT RIGHT STOP	3130-163-D012	1
51	FLANC DROIT ROULEAU AV.	RIGHT FLANGE - FRONT ROLLER	3130-270-D123	1
52	POIGNEE DE MANIVELLE	CRANK HANDLE	610-1009	2
53	VIS T.H 10 * 25 DIN 933	SCREW T.H 10 * 25 DIN 934	850.2003	2
54	VIS T.H 12 * 110	SCREW T.H 12 * 111	850-2048	1
	ECROU M 12 DIN 985	NUT M 12 DIN 986	260-1012	1
55	BROCHE A POIGNEE	DRIFT WITH HANDLE	151-1002	1
56	VIS T.H 10 * 75	SCREW T.H 10 * 76	850-1013	2
	ECROU M 10 DIN 985	NUT M 10 DIN 986	260-1011	2
57	TIRANT DROIT	RIGHT TIE ROD - TOPLINK	3130-760-D182	1
58	VIS T.H 12 * 30	SCREW T.H 12 * 31	850-2016	8
	RONDELLE W 12 ZBJ	WASHER W 12 ZBJ	695-1019	8
59	CHARNIERE DE GRILLE	HINGE	5100-240-1005	2
60	VIS T.H 12 * 25	SCREW T.H 12 * 26	850-1010	4
	ECROU M 12 DIN 985	NUT M 12 DIN 986	260-1012	4



**NOMENCLATURE PLANCHE N°3 ED 130****SPARE PARTS DRAWING NR 3 ED 130**

<b>REP NR</b>	<b>DESIGNATION (Français)</b>	<b>DESIGNATION (english)</b>	<b>REFERENCES PIECES</b>	<b>QTE QTY</b>
1	CLE DE BLOCAGE	LOCKING KEY	530.1007	1
2	CLE DE SERRAGE	TIGHTENING KEY	530.1008	1