

Planche n°7

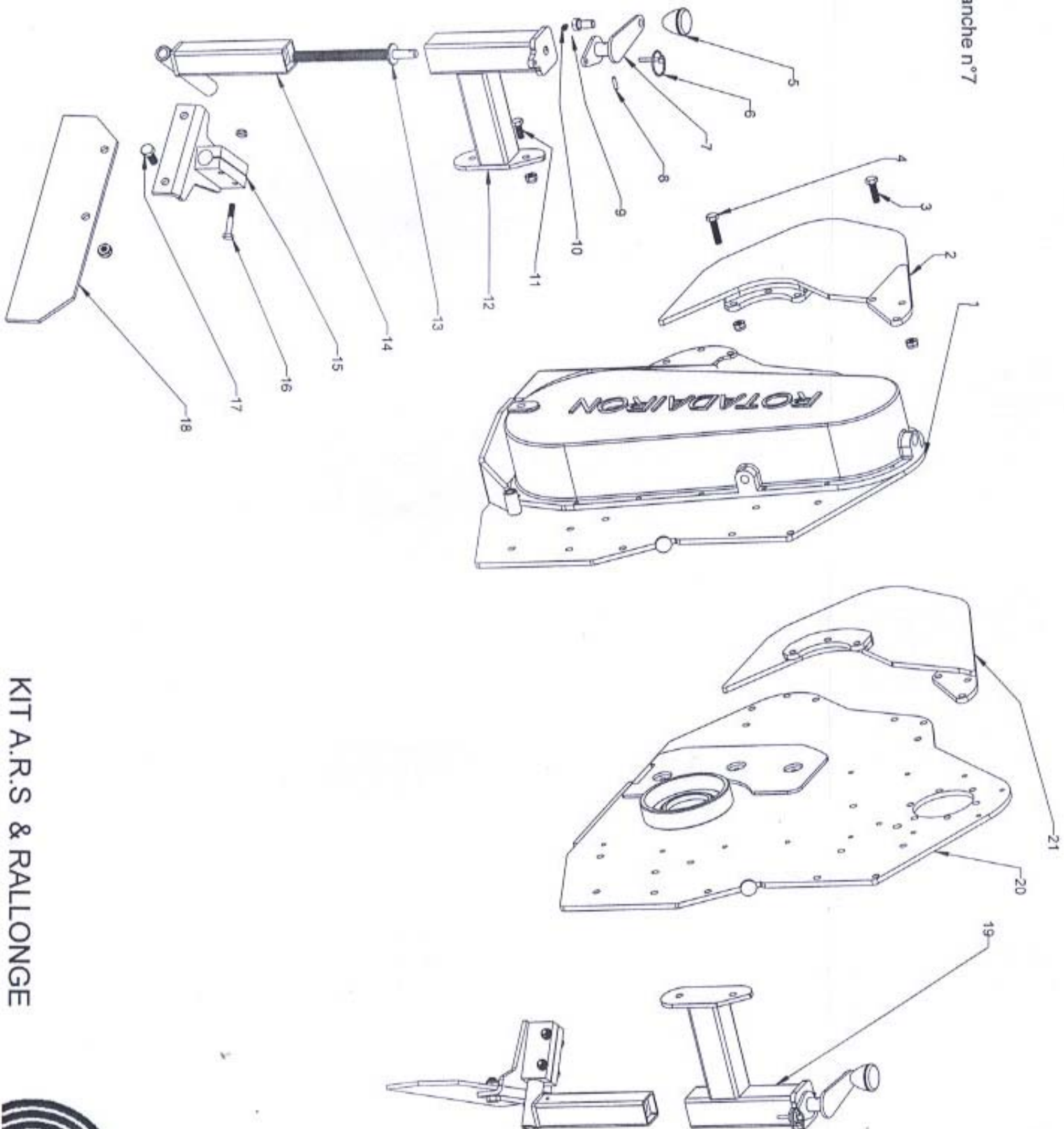

KIT A.R.S & RALLONGE



MONTAGE ARS



Planche n°8





Montage des chaines
de décompactage

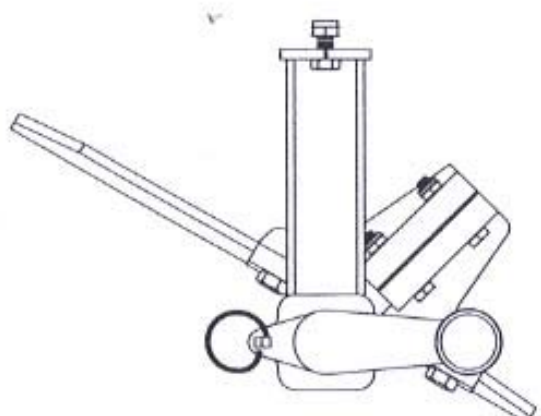
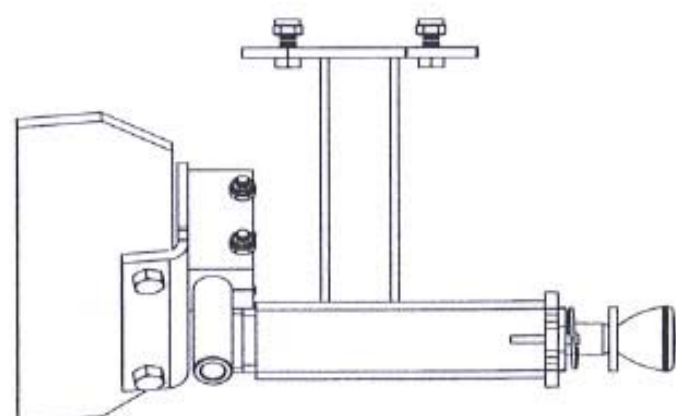
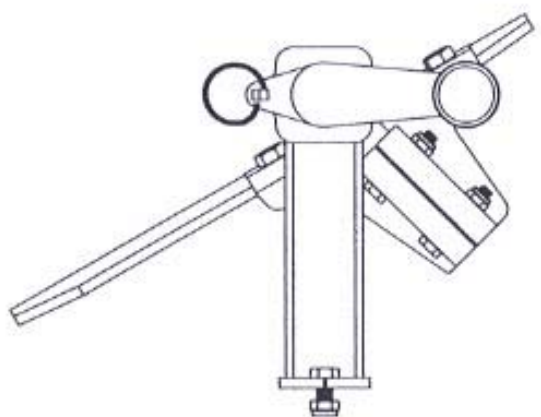
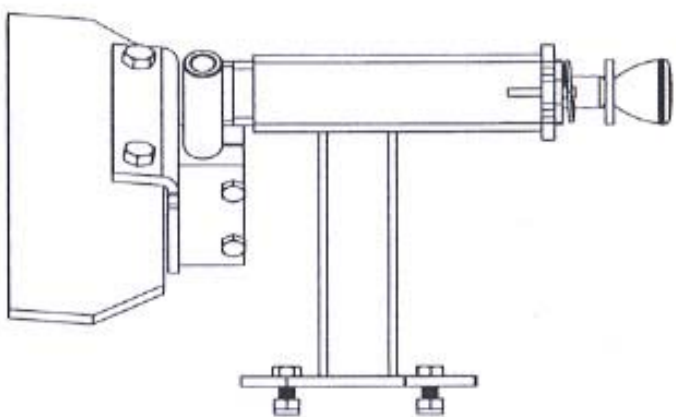
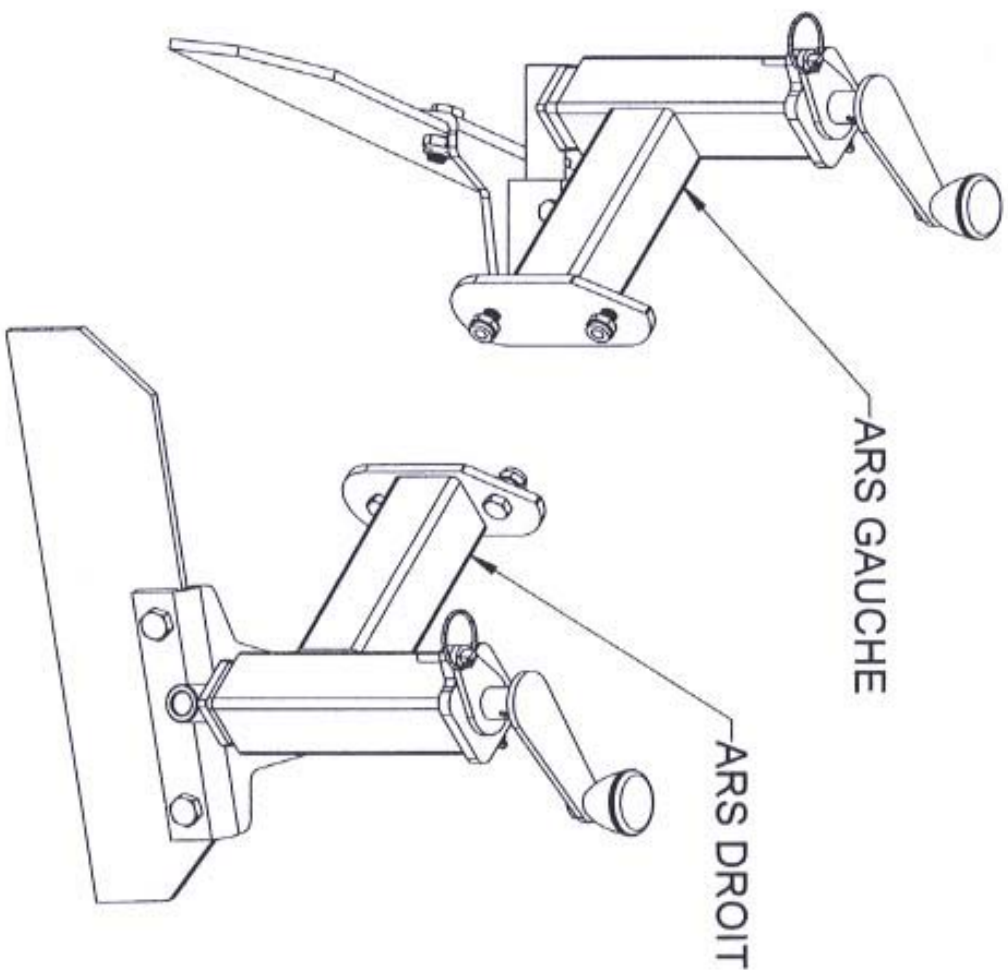
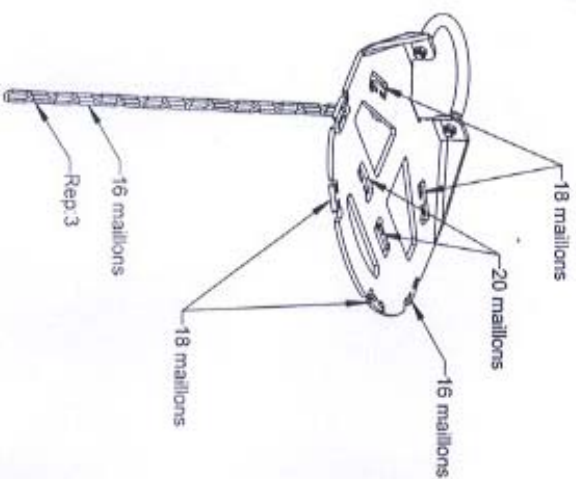
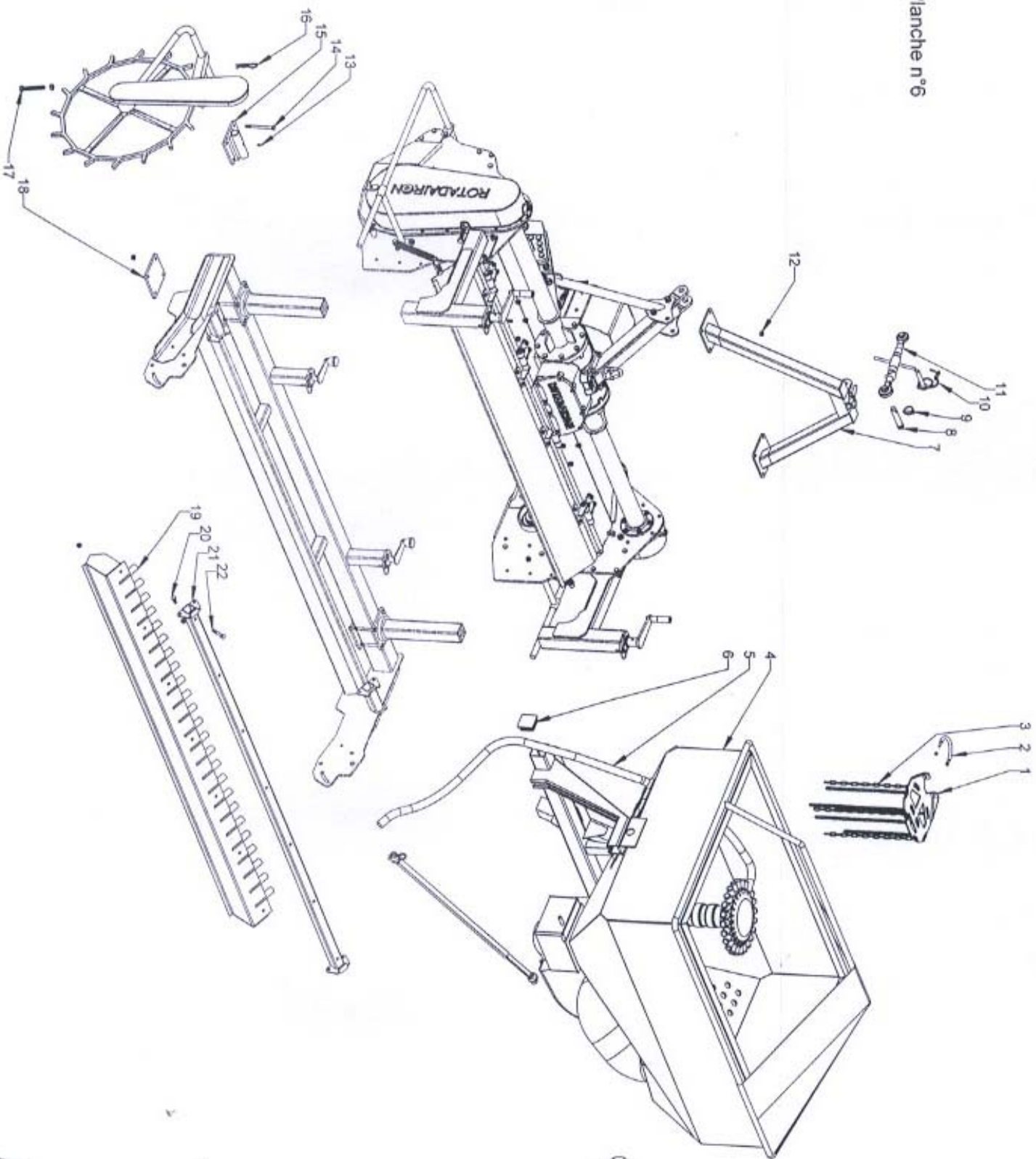



Planche n°1

BOITIER + TROMPETTES RX 220 / 250 / 300



Planche n°2

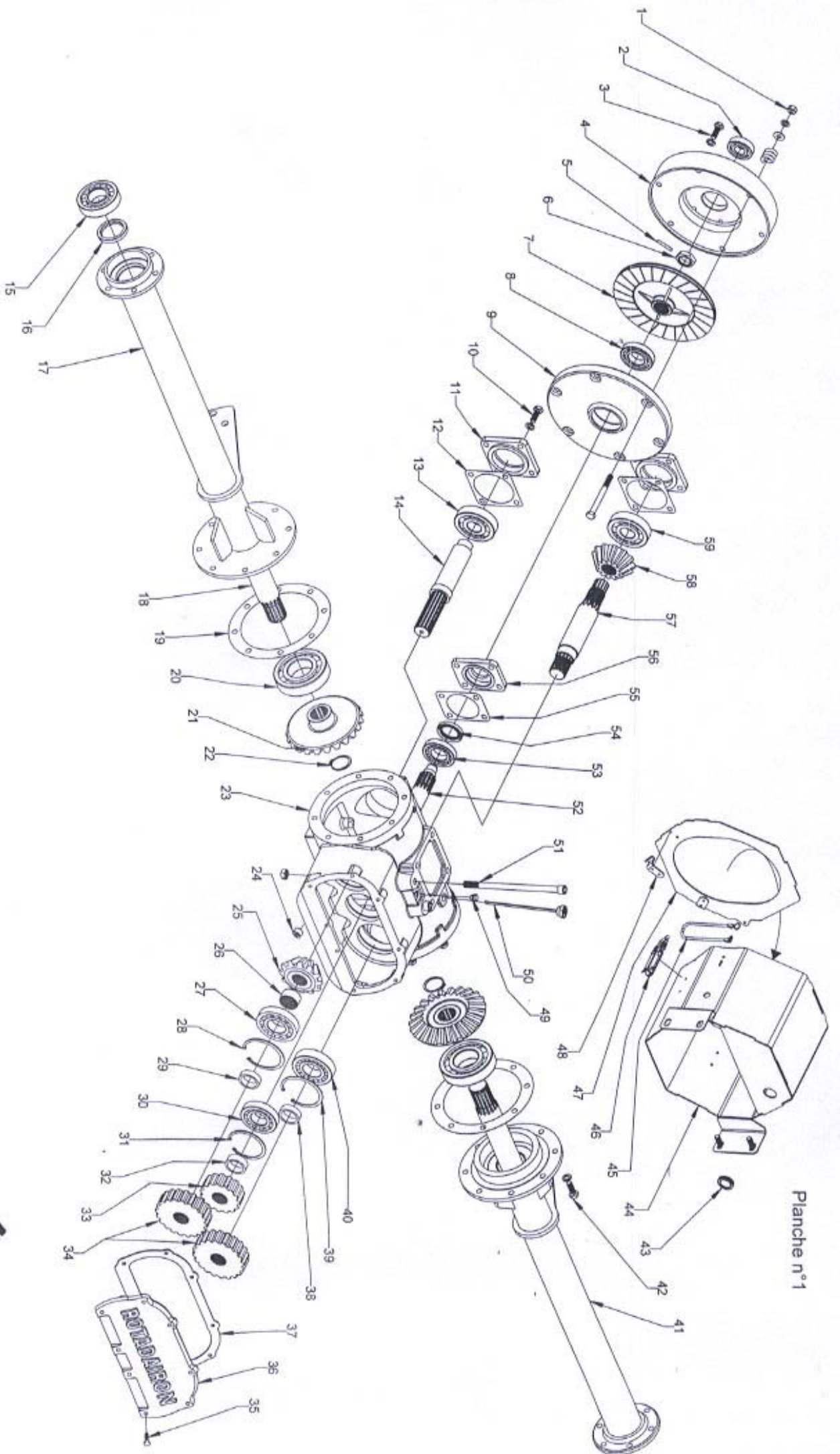
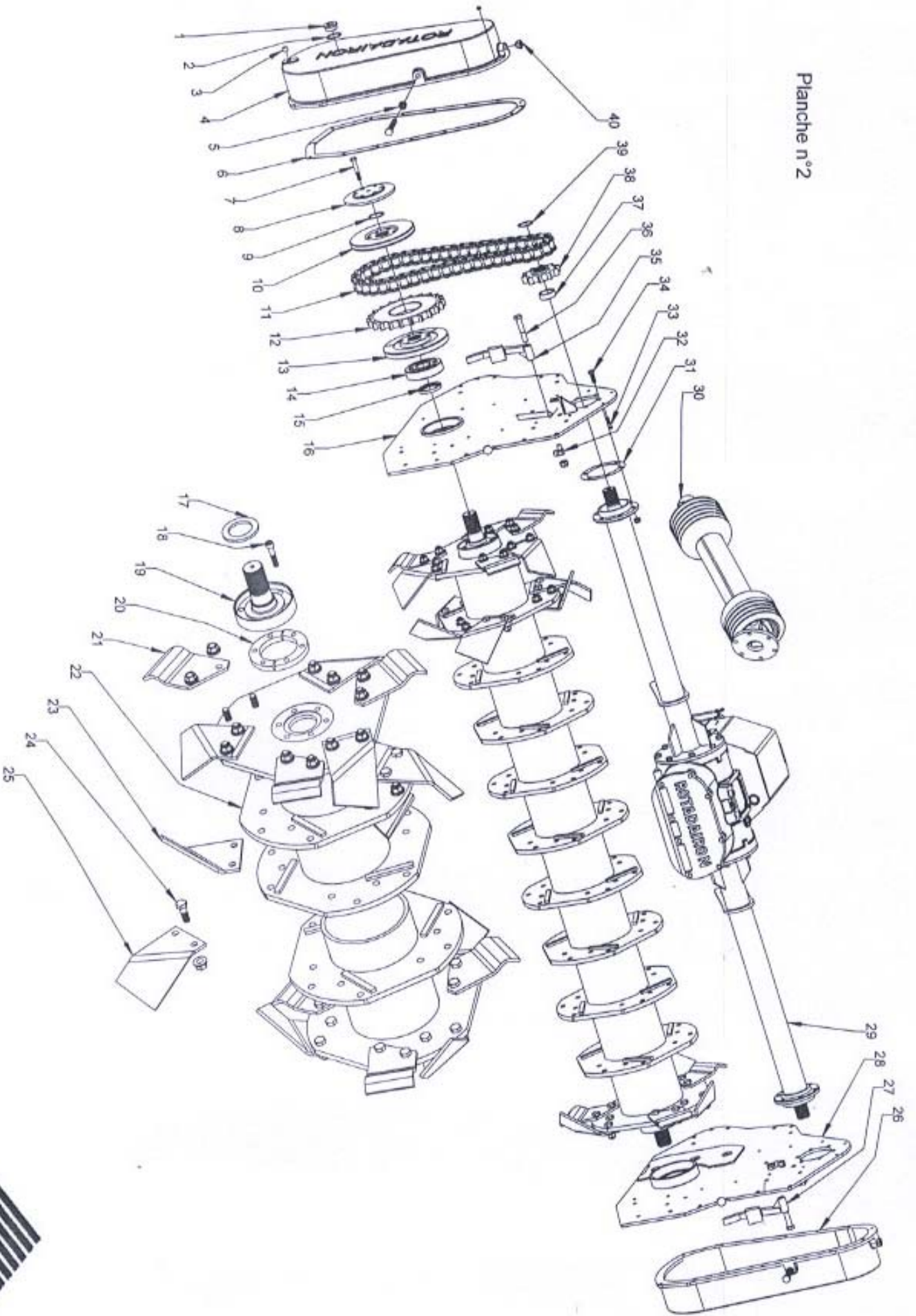

PARTIE ENTRAINEMENT RX 220 / 250 / 300



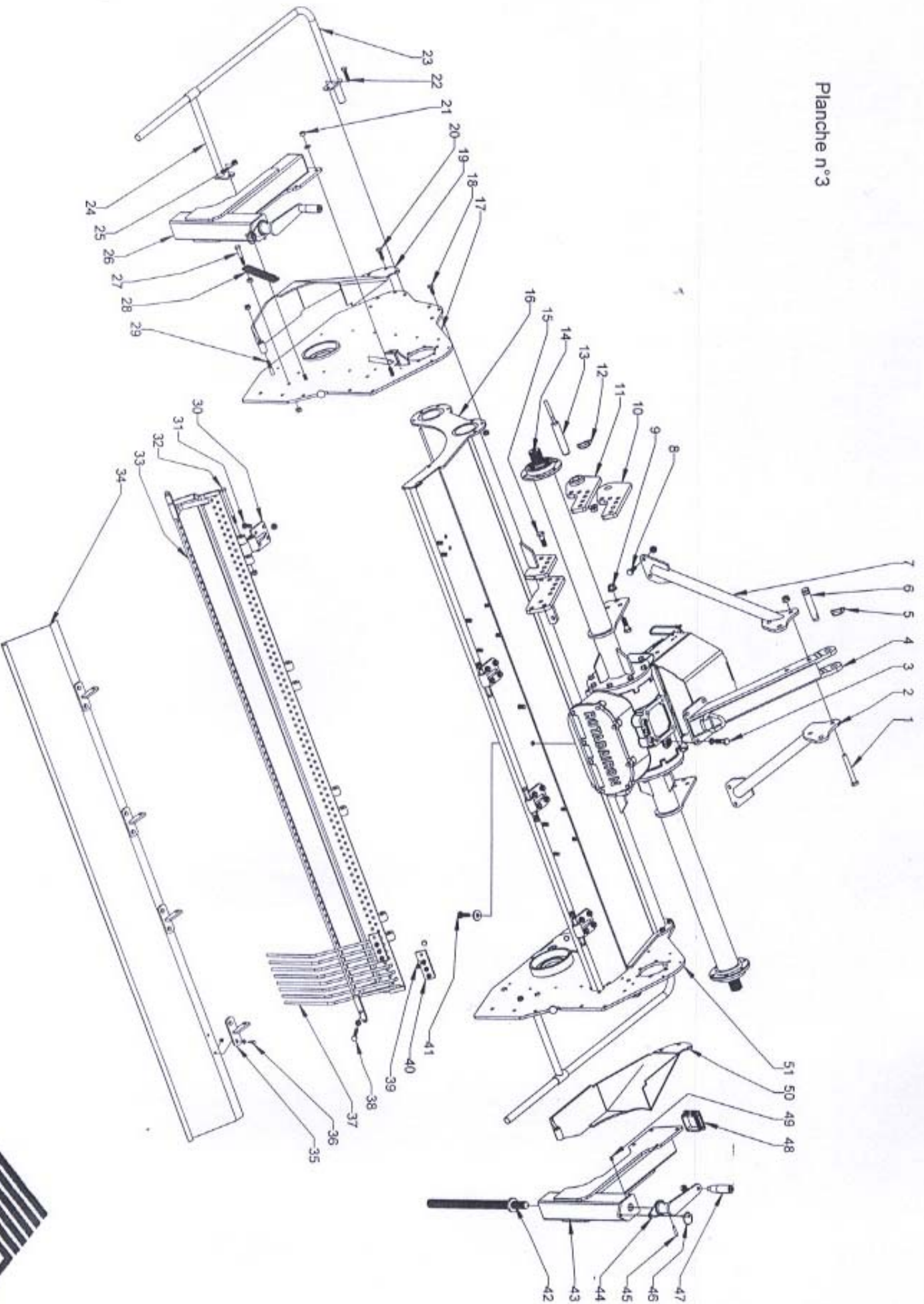

CARROSSERIE RX 220 / 250 / 300



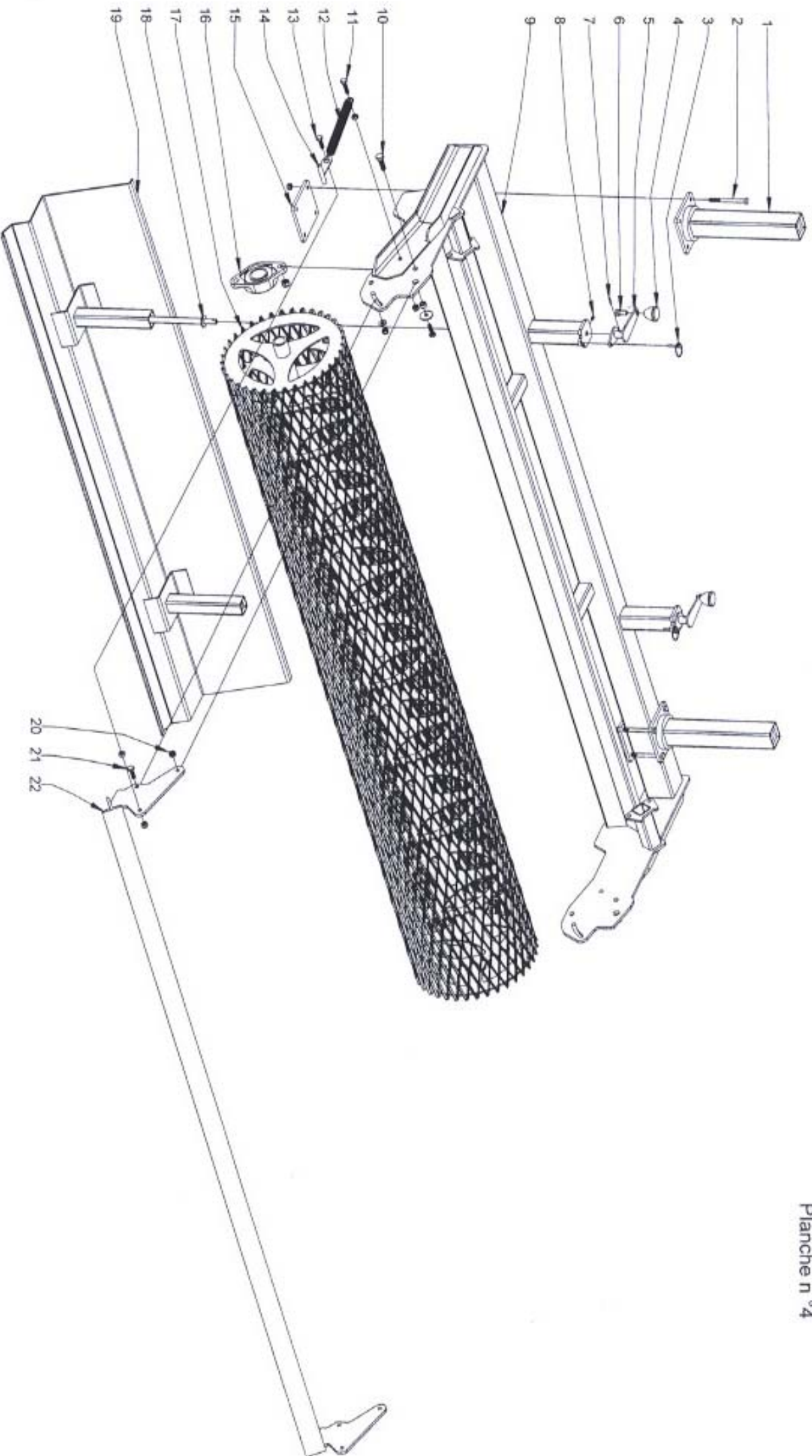

CHASSIS METAL DEPLOYE RX 220 / 250 / 300





Planche n°5

CHASSIS DISQUES CRENELES RX 220 / 250 / 300

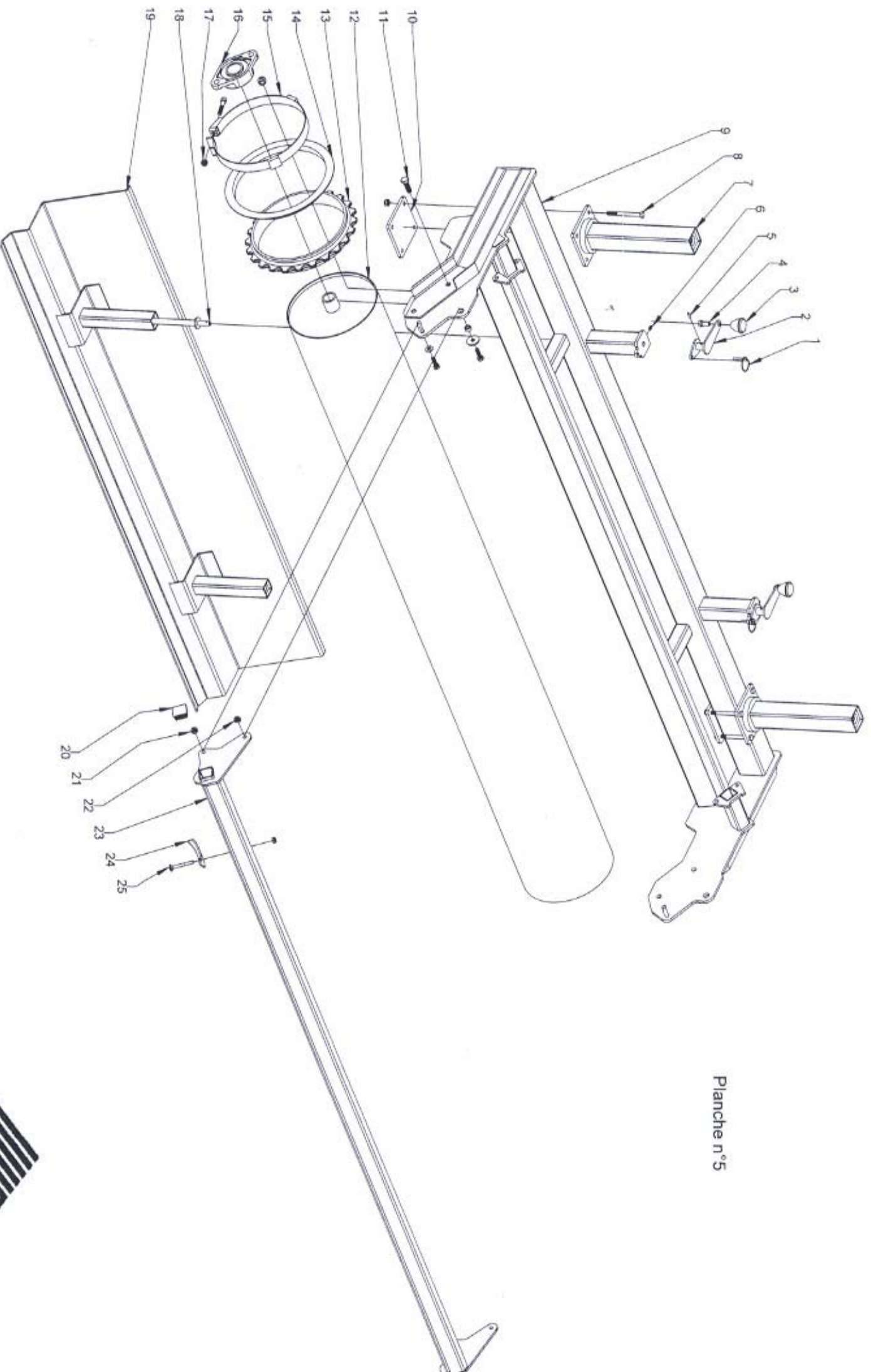

SPARE PARTS LIST DRAWING N° 1 RX 220 / 250 / 300

NR	DESIGNATION	PARTS REFERENCES					
		RX 220	QTY	RX 250	QTY	RX 300	QTY
1	SCREW T.H 12 * 130 ZBJ	850-2013	6	850-2013	6	850-2013	6
	CLUTCH SPRING ZBJ	660-1004	6	660-1004	6	660-1004	6
	WASHER MU 12 ZBJ	695-1018	6	695-1018	6	695-1018	6
	WASHER W 12 ZBJ	695-1019	6	695-1019	6	695-1019	6
	NUT M 12 ZBJ 4032	260-1014	6	260-1014	6	260-1014	6
2	BALL BEARING 6 305 2 RS	690-1006	1	690-1006	1	690-1006	1
3	SCREW T.H 12 * 35 ZBJ	850-2018	6	850-2018	6	850-2018	6
	WASHER W 12 ZBJ	695-1019	6	695-1019	6	695-1019	6
4	FRONT WHEEL 302.55	800-1002	1	800-1002	1	800-1002	1
5	NUT M 30 * 200 G	260-1007	1	260-1007	1	260-1007	1
6	PIN 6 * 40	340-1009	1	340-1009	1	340-1009	1
7	CLUTCH DISC	5150-257-1001	1	5150-257-1001	1	5150-257-1001	1
8	BALL BEARING 6 208 2 RS	690-1005	1	690-1005	1	690-1005	1
9	REAR WHEEL 302.40	800-1001	1	800-1001	1	800-1001	1
10	SCREW T.H 12 * 35 ZBJ	850-2018	12	850-2018	12	850-2018	12
	WASHER W 12 ZBJ	695-1019	12	695-1019	12	695-1019	12
11	CAP Ø 100	178-1002	2	178-1002	2	178-1002	2
12	PAPER GASKET Ø 100	415-1008	2	415-1008	2	415-1008	2
13	BALL BEARING 6 407	690-1008	1	690-1008	1	690-1008	1
14	INTERMEDIATE SHAFT	100-1010	1	100-1010	1	100-1010	1
15	BALL BEARING NU 309	690-1019	2	690-1019	2	690-1019	2
16	PACKING RING 50.72.10 SL	400-1004	2	400-1004	2	400-1004	2
17	LEFT TRUMPET	5250-760-G037	1	5255-760-G097	1	5300-760-G043	1
18	SECONDARY SHAFT	100-1012	2	100-1057	2	100-1015	1
19	PAPER GASKET Ø 190	415-1003	2	415-1003	2	415-1003	2
20	BALL BEARING 6 312	690-1010	2	690-1010	2	690-1010	2
21	BEVEL WHEEL 23 DENTS	600-1006	2	600-1006	2	600-1006	2
22	CIRCLIPS EXT. Ø 45	190-1003	2	190-1003	2	190-1003	2
23	NON PARRALEL CHAIN CASE	180-1008	1	180-1008	1	180-1008	1
24	CAP HC 1/2 G	155-1005	1	155-1005	1	155-1005	1
25	BEVEL GEAR 12 TEETH	600-1003	1	600-1003	1	600-1003	1
26	BROACHED RING	140-1002	1	140-1002	1	140-1002	1
27	BALL BEARING 30 309 R	690-1015	1	690-1015	1	690-1015	1
28	CIRCLIPS INT Ø 100	190-1006	1	190-1006	1	190-1006	1
29	SPACER	139-1008	1	139-1008	1	139-1008	1
30	BALL BEARING 30 308	690-1014	1	690-1014	1	690-1014	1
31	CIRCLIPS 90 INT.	190-1005	1	190-1005	1	190-1005	1
32	SPACER	139-1001	1	139-1001	1	139-1001	1
33	TIMING GEAR	600-1016	1	600-1016	1	600-1016	1
34	TIMING GEAR	600-1017	2	600-1017	2	600-1017	2
35	SCREW T.H 8 * 30 ZBJ	850-2021	8	850-2021	8	850-2021	8
36	CAP	197-1002	1	197-1002	1	197-1002	1
37	CORK GASKET FOR CAP	420-1006	1	420-1006	1	420-1006	1
38	SPACER	139-1008	1	139-1008	1	139-1008	1
39	CIRCLIPS 100 INT.	190-1006	1	190-1006	1	190-1006	1
40	BALL BEARING 21309	690-1016	1	690-1016	1	690-1016	1
41	RIGHT TRUMPET	5250-760-D037	1	5255-760-D097	1	5300-760-D043	1
42	SCREW T.H 12 * 35 ZBJ	850-1018	16	850-1018	16	850-1018	16
	WASHER W 12 ZBJ	695-1019	16	695-1019	16	695-1019	16
43	CAP	156-1005	1	156-1005	1	156-1005	1
44	INTERTIA WHEEL GUARDING	5300-640-1009	1	5300-640-1009	1	5300-640-1009	1
45	FITTING FLY WHEEL GUARDING	900-1004	1	900-1004	1	900-1004	1
46	GASKET	900-1002	2	900-1002	2	900-1002	2
47	PLATE FLY WHEEL GUARDING	640-1095	1	640-1095	1	640-1095	1
48	HOOK FLY WHEEL GUARDING	900-1003	2	900-1003	2	900-1003	2
49	BREATHER 1/8 G	670-1002	1	670-1002	1	670-1002	1
50	DIPSTICK	390-1001	1	390-1001	1	390-1001	1
51	SCREW CHC 14 * 250	850-3001	2	850-3001	2	850-3001	2
	NUT M14 ZBJ 4032	260-1018	2	260-1018	2	260-1018	2
52	PRIMARY SHAFT	100-1004	1	100-1004	1	100-1004	1
53	BALL BEARING 30 208	690-1013	1	690-1013	1	690-1013	1
54	PACKING RING 40.62.10 DL	400-1003	1	400-1003	1	400-1003	1
55	PAPER GASKET	415-1004	1	415-1004	1	415-1004	1
56	CENTRAL CAP 22 D	178-1003	1	178-1003	1	178-1003	1
57	INTERMEDIATE SHAFT	100-1009	1	100-1009	1	100-1009	1
58	BEVEL GEAR 12 TEETH	600-1003	1	600-1003	1	600-1003	1
59	BALL BEARING 6 407	690-1008	1	690-1008	1	690-1008	1

SPARE PARTS LIST DRAWING N° 2 RX 220 / 250 / 300

NR	DESIGNATION	PARTS REFERENCES					
		RX 220	QTY	RX 250	QTY	RX 300	QTY
1	CAP M45 * 200	155-1002	2	155-1002	2	155-1002	2
2	GASKET	410-1001	2	410-1001	2	410-1001	2
3	CAP HC 3/8 G	155-1001	2	155-1001	2	155-1001	2
4	LEFT CHAIN CASE	180-G005	1	180-G005	1	180-G005	1
5	SCREW T.H 16 * 110 DIN 931 ZBJ	850-2010	2	850-2010	2	850-2010	2
	NUT M 16 , 4032	260-1015	2	260-1015	2	260-1015	2
6	CORK GASKET	420-1005	2	420-1005	2	420-1005	2
7	SCREW T.H 12 * 70 CL 10.9	850-2026	12	850-2026	12	850-2026	12
8	CUP SPRING	695-1030	2	695-1030	2	695-1030	2
9	CIRCLIPS 50 EXT.	190-1004	2	190-1004	2	190-1004	2
10	HYDRAULIC CLUTCH DISC EXT.	5250-250-1005	2	5250-250-1005	2	5250-250-1005	2
11	CHAIN 44 CHAIN LINKS	175-1004	2	175-1004	2	175-1004	2
12	PITCH CHAIN WHEEL	5250-600-1033	2	5250-600-1033	2	5250-600-1033	2
13	HYDRAULIC CLUTCH DISC INT.	5250-250-1006	2	5250-250-1006	2	5250-250-1006	2
14	BALL BEARING 6410	690-1009	2	690-1009	2	690-1009	2
15	SERIAL NO OF MACHINE <	890		463		756	
	PACKING RING 54 * 72 * 10	400-1005	2	400-1005	2	400-1005	2
15	SERIAL NO OF MACHINE >	890		463		756	
	PACKING RING 60 * 80 * 10	400-1011	2	400-1011	2	400-1011	2
16	LEFT SIDE	5250-195-G008	2	5250-195-G008	2	5250-195-G008	2
17	FELT RING	415-1001	2	415-1001	2	415-1001	2
18	SCREW CHC M12 * 60 CL 12.9	850-3017	12	850-3017	12	850-3017	12
19	SERIAL NO OF MACHINE <	890				756	
	TRANSMISSION DISC	5250-630-1002	2	5250-630-1002	2	5250-630-1002	2
19	SERIAL NO OF MACHINE >	890				756	
	TRANSMISSION DISC	5250-630-1012	2	5250-630-1012	2	5250-630-1012	2
20	WASHER 1/2 NUT	695-1012	2	695-1012	2	695-1012	2
21	EXTERIOR BLADE 120 * 8	450-1008	6	450-1008	6	450-1008	6
22	ROTOR	5250-760-1008	1	5255-760-1092	1	5300-760-1024	1
23	LEFT BLADE 120 * 8	450-1004	30	450-1004	33	450-1004	42
24	SCREW T.H 16 * 150 * 47 CL 12.9	850-1004	132	850-1004	144	850-1001	180
	NUT M16 * 150	260-1003	132	260-1003	144	260-1003	180
25	RIGHT BLADE 120 * 8	450-1006	30	450-1006	33	450-1006	42
26	RIGHT CHAIN CASE	180-D005	1	180-D005	1	180-D005	1
27	RIGHT CHAIN TIGHTENER	5250-730-1004	1	5250-730-1004	1	5250-730-1004	1
28	RIGHT SIDE	5250-195-D008	1	5250-195-D008	1	5250-195-D008	1
29	SEE DRAWING N°1						
30	TRANSMISSION 1" 3/8 6 Can	094-1004	1	094-1004	1	094-1004	1
31	PAPER GASKET	415-1002	2	415-1002	2	415-1002	2
32	BREATHER G 13-8x13	265-1002	2	265-1002	2	265-1002	2
33	SCREW T.H 8 * 35 ZBJ	850-2020	28	850-2020	28	850-2020	28
	NUT M8 ZBJ DIN 985	260-1010	28	260-1010	28	260-1010	28
34	SCREW T.H 12 * 35	850-1018	12	850-1018	12	850-1018	12
	NUT M12 DIN 985	260-1012	12	260-1012	12	260-1012	12
35	LEFT CHAIN TIGHTENER	5150-730-1004	1	5150-730-1004	1	5150-730-1004	1
36	SCREW T.H 16 * 90	850-1020	2	850-1020	2	850-1020	2
	NUT M 16 DIN 985	260-1008	2	260-1008	2	260-1008	2
37	SPACER	139-1005	2	139-1005	2	139-1005	2
38	PITCH CHAIN WHEEL	600-1008	2	600-1008	2	600-1008	2
39	CIRCLIPS 45 EXT.	190-1003	2	190-1003	2	190-1003	2
40	CAP	155-1003	2	155-1003	2	155-1003	2

SPARE PARTS LIST DRAWING N°3 RX 220 / 250 / 300

1/2

NR	DESIGNATION	PARTS REFERENCES					
		RX 220	QTY	RX 250	QTY	RX 300	QTY
1	SCREW T.H 16 * 120	850-1056	2	850-1056	2	850-1056	2
	NUT M16 DIN 985	260-1008	2	260-1008	2	260-1008	2
2	RIGHT TOPLINK TUBE	5250-760-D066	1	5250-760-D066	1	5250-760-D066	1
3	SCREW T.H 14 * 50	850-1036	4	850-1036	4	850-1036	4
	WASHER W 14	695-1026	4	695-1026	4	695-1026	4
4	HITCHING	5250-640-1027	1	5250-640-1027	1	5250-640-1027	1
5	PIN Ø11	340-1004	1	340-1004	1	340-1004	1
6	HITCHING AXIS Ø25	120-1003	1	120-1003	1	120-1003	1
7	LEFT TOPLINK TUBE	5250-760-G066	1	5250-760-G066	1	5250-760-G066	1
8	SCREW T.H 14 * 35 DIN 933	850-2019	4	850-2019	4	850-2019	4
	NUT M 14 DIN 985	260-1013	4	260-1013	4	260-1013	4
9	SCREW T.H 16 * 150 * 47 CL 12.9	850-1004	6	850-1004	6	850-1004	12
	NUT M 16 * 150	260-1003	6	260-1003	6	260-1003	12
10	RIGHT LINK TUBE	5250-620-D021	2	5250-620-D021	2	5250-620-D021	2
11	LEFT LINK TUBE	5250-620-G021	2	5250-620-G021	2	5250-620-G021	2
12	PIN Ø11	340-1004	2	340-1004	2	340-1004	2
13	HITCHING AXIS Ø28	120-1004	2	120-1004	2	120-1004	2
14	SEE DRAWING N° 1						
15	SCREW T.H 16 * 150 * 47 CL 12.9	850-1004	24	850-1004	24	850-1004	24
	NUT M 16 * 150	260-1003	24	260-1003	24	260-1003	24
16	COVER	5250-770-1002	1	5255-770-1123	1	5300-770-1001	1
17	LEFT SIDE	5250-195-G008	1	5250-195-G008	1	5250-195-G008	1
18	SCREW T.H 12 * 30	850-2016	8	850-2016	8	850-2016	8
	NUT M 12 DIN 985	260-1012	8	260-1012	8	260-1012	8
19	PROTECTION LEFT SIDE	5250-710-G004	1	5250-710-G004	1	5250-710-G004	1
20	SCREW T.H 12 * 40	850-2007	4	850-2007	4	850-2007	4
	NUT M 12 DIN 985	260-1012	4	260-1012	4	260-1012	4
21	SCREW T.H 1/2 * 43 CL 12.9	850-2032	8	850-2032	8	850-2032	8
	NUT 1/2 ZBJ	260-2001	8	260-2001	8	260-2001	8
	WASHER W 12 ZBJ	695-1019	8	695-1019	8	695-1019	8
22	SCREW T.H 12 * 50	850-2012	2	850-2012	2	850-2012	2
	NUT M 12 DIN 985	260-1012	2	260-1012	2	260-1012	2
23	GUARDING TUBE	5250-760-1206	2	5250-760-1206	2	5250-760-1206	2
24	DISTANCE PIECE RING	5250-760-1213	2	5250-760-1213	2	5250-760-1213	2
25	SCREW T.H 12 * 30	850-2016	2	850-2016	2	850-2016	2
	NUT M 12 DIN 985	260-1012	2	260-1012	2	260-1012	2
26	LEFT ARM	5250-750-G130	1	5250-750-G130	1	5250-750-G130	1
27	SCREW T.H 12 * 70	850-2015	2	850-2015	2	850-2015	2
	NUT M 12 4032	260-1014	2	260-1014	2	260-1014	2
	NUT M 12 DIN 985	260-1012	2	260-1012	2	260-1012	2
28	SPRING	660-1005	2	660-1005	2	660-1005	2
29	SCREW T.H 12 * 70	850-2015	2	850-2015	2	850-2015	2
	NUT M 12 DIN 985	260-1012	2	260-1012	2	260-1012	2
30	GRATE HINGE	5250-640-1015	4	5250-640-1015	4	5250-640-1015	6
31	SCREW T.H 12 * 30	850-1014	8	850-1014	8	850-1014	12
	NUT M 12 DIN 985	260-1012	8	260-1012	8	260-1012	12
32	SCREW T.H 12 * 140	850-2004	4	850-2004	4	850-2004	6
	NUT M 12 DIN 985	260-1012	4	260-1012	4	260-1012	6
33	GRATE	5250-770-1051	1	5255-770-1127	1	5300-770-1014	1
34	SHUTTER	770-1044	1	770-1126	1	770-1013	1
35	SHUTTER HINGE	5250-640-1022	4	5250-640-1022	4	5250-640-1022	6
36	SCREW T.H 8 * 25	850-2024	8	850-2024	8	850-2024	12
	WASHER MU Ø8	695-1062	8	695-1062	8	695-1062	12
	NUT M8 DIN 985	260-1010	8	260-1010	8	260-1010	12
37	GRATE FINGER	210-1003	73	210-1003	82	210-1003	100
38	SCREW T.H 12 * 80 DIN 933	850-2014	2	850-2014	2	850-2014	2
	NUT M 12 4032	260-1014	2	260-1014	2	260-1014	2
39	SCREW CHC 10 * 35	850-3002	72	850-3002	81	850-3002	99
	NUT M 10 DIN 985	260-1011	72	260-1011	81	260-1011	99
40	GRATE FINGER FLANGE	150-1001	18	150-1001	20	150-1001	25
41	SCREW T.H 14 * 40	850-1054	2	850-1054	2	850-1054	2
	WASHER	695-1001	2	695-1001	2	695-1001	2

SPARE PARTS LIST DRAWING N°3 RX 220 / 250 / 300

2/2

NR	DESIGNATION	PARTS REFERENCES					
		RX 220	QTY	RX 250	QTY	RX 300	QTY
42	CRANK SCREW	5220-850-1042	2	5220-850-1042	2	5220-850-1042	2
43	RIGHT ARM	5250-750-D130	1	5250-750-D130	1	5250-750-D130	1
44	CRANK	5250-640-1038	2	5250-640-1038	2	5250-640-1038	2
45	PIN 8 * 40	340-1010	2	340-1010	2	340-1010	2
46	PIN Ø6	340-1005	2	340-1005	2	340-1005	2
47	CRANK HANDLE	610-1002	2	610-1002	2	610-1002	2
	NUT M 14 4032	260-1018	2	260-1018	2	260-1018	2
48	CAP	156-1004	2	156-1004	2	156-1004	2
49	GREASER	320-1001	2	320-1001	2	320-1001	2
50	PROTECTION RIGHT SIDE	5250-710-D004	1	5250-710-D004	1	5250-710-D004	1
51	RIGHT SIDE	5250-195-D008	1	5250-195-D008	1	5250-195-D008	1

SPARE PARTS LIST DRAWING N°4 RX 220 / 250 / 300

NR	DESIGNATION	PARTS REFERENCES					
		RX 220	QTY	RX 250	QTY	RX 300	QTY
1	MALE TUBE	5250-640-1019	2	5250-640-1019	2	5250-640-1019	2
2	SCREW T.H 12 * 130	850-2013	8	850-2013	8	850-2013	8
	NUT M 12 DIN 985	260-1012	8	260-1012	8	260-1012	8
3	PIN Ø6	340-1005	2	340-1005	2	340-1005	2
4	CRANK HANDLE	610-1001	2	610-1001	2	610-1001	2
5	CRANK	5100-640-1001	2	5100-640-1001	2	5100-640-1001	2
6	SCREW T.H 14 * 30 DIN 933	850-2005	2	850-2005	2	850-2005	2
7	PIN Ø6 * 25	340-1007	2	340-1007	2	340-1007	2
8	GREASER	320-1001	2	320-1001	2	320-1001	2
9	FRAME	5250-270-1081	1	5255-270-1081	1	5300-270-1081	1
10	SCREW T.H 16 * 50	850-2033	4	850-2033	4	850-2033	4
	NUT M 16 DIN 985	260-1008	4	260-1008	4	260-1008	4
11	SCREW T.H 12 * 50 DIN 933	850-2012	2	850-2012	2	850-2012	2
	NUT M 12 4032	260-1014	2	260-1014	2	260-1014	2
	NUT M 12 DIN 985	260-1012	2	260-1012	2	260-1012	2
12	SPRING	660-1005	2	660-1005	2	660-1005	2
13	SCREW T.H 12 * 40 DIN 933	850-2007	2	850-2007	2	850-2007	2
	NUT M 12 4032	260-1014	2	260-1014	2	260-1014	2
	NUT M 12 DIN 985	260-1012	2	260-1012	2	260-1012	2
14	SPRING HANDLE	5075-620-1019	2	5075-620-1019	2	5075-620-1019	2
15	FITTING PLATE TUBE	640-1019	2	640-1019	2	640-1019	2
16	BEARING UCFL 210	690-1020	2	690-1020	2	690-1020	2
17	ROLLER	5250-505-1009	1	5255-505-1009	1	5300-505-1009	1
18	CRANK SCREW	5180-850-1043	2	5180-850-1043	2	5180-850-1043	2
19	NIV GRADER	5250-450-1014	1	5255-450-1045	1	5300-450-1015	1
20	SCREW T.H 12 * 40 DIN 933	850-2007	2	850-2007	2	850-2007	2
	WASHER	695-1027	2	695-1027	2	695-1027	2
	SLEEVE	240-1031	2	240-1031	2	240-1031	2
	NUT M 12 DIN 985	260-1012	2	260-1012	2	260-1012	2
21	SCREW T.H 12 * 40 DIN 933	850-2007	2	850-2007	2	850-2007	2
	WASHER MU 12	695-1018	2	695-1018	2	695-1018	2
	NUT M 12 DIN 985	260-1012	2	260-1012	2	260-1012	2
22	SCRAPER	5250-725-1018	1	5255-725-1021	1	5300-725-1015	1
23	CAP	156-1001	2	156-1001	2	156-1001	2

SPARE PARTS LIST DRAWING N°5 RX 220 / 250 / 300

NR	DESIGNATION	PARTS REFERENCES					
		RX 220	QTY	RX 250	QTY	RX 300	QTY
1	PIN Ø6	340-1005	2	340-1005	2	340-1005	2
2	CRANK	5100-640-1001	2	5100-640-1001	2	5100-640-1001	2
3	CRANK HANDLE Ø45	610-1001	2	610-1001	2	610-1001	2
4	SCREW T.H 14 * 30 DIN 933	850-2005	2	850-2005	2	850-2005	2
5	PIN Ø6 * 25	340-1007	2	340-1007	2	340-1007	2
6	GREASER	320-1001	2	320-1001	2	320-1001	2
7	MALE TUBE	5250-640-1019	2	5250-640-1019	2	5250-640-1019	2
8	SCREW T.H 12 * 130	850-2013	8	850-2013	8	850-2013	8
	NUT M 12 DIN 985	260-1012	8	260-1012	8	260-1012	8
9	FRAME	5250-270-1080	1	5255-270-1080	1	5300-270-1080	1
10	FITTING PLATE TUBE	640-1019	2	640-1019	2	640-1019	2
11	SCREW T.H 16 * 50	850-2033	4	850-2033	4	850-2033	4
	NUT M 16 DIN 985	260-1008	4	260-1008	4	260-1008	4
12	ROLLER	5250-760-1067	1	5255-760-1098	1	5300-760-1068	1
13	DISC	158-1002	45	158-1002	50	158-1002	61
14	1/2 DISC	158-1004	2	158-1004	2	158-1004	2
15	DISC CLAMP	158-1006	2	158-1006	2	158-1006	2
16	BEARING UCFL 210	690-1020	2	690-1020	2	690-1020	2
17	SCREW CHC 12 * 60 CL 12.9	850-3017	2	850-3017	2	850-3017	2
	NUT M 12 DIN 985	260-1012	2	260-1012	2	260-1012	2
18	CRANK SCREW	5180-850-1043	2	5180-850-1043	2	5180-850-1043	2
19	NIV GRADER	5250-450-1014	1	5255-4501045	1	5300-450-1015	1
20	CAP	156-1001	2	156-1001	2	156-1001	2
21	SCREW T.H 12 * 40 DIN 933	850-2007	2	850-2007	2	850-2007	2
	WASHER MU 12	695-1018	2	695-1018	2	695-1018	2
	NUT M 12 DIN 985	260-1012	2	260-1012	2	260-1012	2
22	SCREW T.H 12 * 40 DIN 933	850-2007	2	850-2007	2	850-2007	2
	WASHER	695-1027	2	695-1027	2	695-1027	2
	SLEEVE	240-1031	2	240-1031	2	240-1031	2
	NUT M 12 DIN 985	260-1012	2	260-1012	2	260-1012	2
23	SCRAPER	5250-750-1017	1	5255-750-1168	1	5300-750-1018	1
24	SCRAPER TEETH	200-1001	46	200-1001	51	200-1001	62
25	SCREW TRCC 10 * 80	850-2034	46	850-2034	51	850-2034	62
	NUT M 10 DIN 985	260-1011	46	260-1011	51	260-1011	62
26	CAP	156-1001	2	156-1001	2	156-1001	2

SPARE PARTS LIST DRAWING N° 6 RMA 220 / 250 / 300

NR	DESIGNATION	PARTS REFERENCES					
		RMA 220	QTY	RMA 250	QTY	RMA 300	QTY
1	CHAIN SUPPORT	640-1125	1	640-1125	1	640-1125	1
2	SCREWED SPINDLE	740-1003	1	740-1003	1	740-1003	1
	PROTECTION CASE	295-1004	1	295-1004	1	295-1004	1
	NUT M8 DIN 985	260-1010	2	260-1010	2	260-1010	2
3	CHAINE CASE REPL. KIT	175-1022	1	175-1022	1	175-1022	1
4	PNEUMATIC SEEDER	SEE MANUAL OF THE SEEDER					
5	FEED PIPE Ø30						
6	CAP SQUARE 80	156-1004	2	156-1004	2	156-1004	2
7	ADAPTATION TRIANGLE	5300-110-1010	1	5300-110-1010	1	5300-110-1010	1
8	HITCHING AXIS Ø25	120-1003	1	120-1003	1	120-1003	1
9	PIN Ø11	340-1004	1	340-1004	1	340-1004	1
10	DRIFT Ø19 * 115	151-1002	1	151-1002	1	151-1002	1
11	PUSH ROD	142-1002	1	142-1002	1	142-1002	1
12	NUT M 12 DIN 985	260-1012	8	260-1012	8	260-1012	8
13	GREASER M8	320-1001	1	320-1001	1	320-1001	1
14	SCREW T.H 12 * 140	850-2004	4	850-2004	4	850-2004	4
	NUT M 12 DIN 985	260-1012	4	260-1012	4	260-1012	4
15	WHEEL SUPPORT	5300-240-1078	1	5300-240-1078	1	5300-240-1078	1
16	BETA Ø6 PEG	340-1001	2	340-1001	2	340-1001	2
17	SCREW T.H 16 * 110 DIN 931	850-2010	1	850-2010	1	850-2010	1
	NUT M 16 , 4032	260-1015	1	260-1015	1	260-1015	1
18	FITTING PLATE TUBE	640-1019	1	640-1019	1	640-1019	1
19	SEEDING RAMP	5250-770-1128	1	5255-770-1194	1	5300-770-D112	1
						5300-770-G112	1
20	SCREW T.H 12 * 30	850-2016	4	850-2016	4	850-2016	6
	NUT M 12 DIN 985	260-1012	4	260-1012	4	260-1012	6
21	RAMP SUPPORT	5250-750-1185	1	5255-750-1279	1	5300-750-1135	2
22	SCREW T.H 12 * 70	850-2015	7	850-2015	7	850-2015	8
	NUT M12 DIN 985	260-1012	7	260-1012	7	260-1012	8

SPARE PARTS LIST DRAWING N°7 KITS

NR	DESIGNATION	PARTS REFERENCES	QTY
1	LEFT SIDE		
2	LEFT EXTENSION	5300-195-G020	1
3	SCREW T.H 12 * 50	850-2012	6
	NUT M 12 DIN 985	260-1012	6
4	SCREW T.H 12 * 40	850-2007	6
	NUT M 12 DIN 985	260-1012	6
5	CRANK HANDLE Ø45	610-1001	2
6	PIN Ø6	340-1005	2
7	CRANK	5100-640-1001	2
8	PIN Ø6 * 25	340-1007	2
9	SCREW T.H 14 * 30 DIN 933	850-2005	2
10	GREASER M8	320-1001	2
11	SCREW T.H 12 * 30	850-2016	4
	NUT M 12 DIN 985	260-1012	4
12	LEFT FEMALE PIPE	5250-640-G026	1
13	CRANK SCREW	5100-850-1039	2
14	MALE PIPE	5250-760-1080	2
15	LEFT BLADE SUPPORT	5250-550-G001	1
16	SCREW T.H 10 * 60	850-2053	4
	NUT M10 DIN 985	260-1011	4
17	SCREW T.H 14 * 35 DIN 933	850-2019	4
	NUT M14 DIN 985	260-1013	4
18	BLADE	450-1018	2
19	RIGHT FEMALE PIPE	5250-640-D026	1
20	RIGHT SIDE		
21	RIGHT EXTENSION	5300-195-D020	1